



# *Government Gazette*

OF THE STATE OF

NEW SOUTH WALES

**Week No. 29/2011**

**Friday, 22 July 2011**

*Published under authority by  
Department of Premier and Cabinet  
Level 11, Bligh House  
4-6 Bligh Street, SYDNEY NSW 2001  
Phone: 9228 3288 Fax: 9372 7422  
Email: [nswgazette@dpc.nsw.gov.au](mailto:nswgazette@dpc.nsw.gov.au)*

*Containing numbers 73, 74, 75 and 76  
Pages 5019 – 5072*

# CONTENTS

## Number 73

### SPECIAL SUPPLEMENT

State Owned Corporations (Portfolio Minister) Amendment Order 2011 .....	5019
---	------

## Number 74

### SPECIAL SUPPLEMENT

Fisheries Management Act 1994 .....	5021
-------------------------------------	------

## Number 75

### SPECIAL SUPPLEMENT

Animal Diseases (Emergency Outbreaks) Act 1991 .....	5029
---	------

## Number 76

### LEGISLATION

Online notification of the making of Statutory Instruments .....	5031
Other Legislation .....	5032

### OFFICIAL NOTICES

Appointments .....	5037
Department of Primary Industries .....	5038
Lands .....	5044
Water .....	5055
Roads and Traffic Authority .....	5056
Other Notices .....	5064

### PRIVATE ADVERTISEMENTS

(Council, Probate, Company Notices, etc) .....	5069
--	------

#### CHANGE OF ADDRESS

Strategic Communications and Government Advertising now comes under the Department of Premier and Cabinet.

Our new address is:

Level 11, Bligh House

4-6 Bligh Street, Sydney NSW 2000

New phone: (02) 9228 3288

New fax: (02) 9372 7422

## DEADLINES

### Attention Advertisers . . .

*Government Gazette inquiry times are:*

*Monday to Friday: 8.30 am to 4.30 pm*

**Phone: (02) 9372 7447 Fax: (02) 9372 7421**

**Email: [nswgazette@services.nsw.gov.au](mailto:nswgazette@services.nsw.gov.au)**

### GOVERNMENT GAZETTE DEADLINES

#### Close of business every Wednesday

Except when a holiday falls on a Friday, deadlines will be altered as per advice given on this page.

### Special Supplements

A Special Supplement or Extraordinary Supplement is a document which has a legal requirement to commence on a certain date and time. Release of Publication is required on the same day. The request for a Supplement is received from the department to the *Government Gazette* by telephone. The copy must be accompanied by a letter or email requesting the Supplement and signed by a Minister or Head of a Department.

**NOTE:** Advance notice of a Special Supplement is essential as early as possible on the day required. On Thursdays early notice is a priority and when possible notice should be given a day prior being the Wednesday.

#### Please Note:

- *Only electronic lodgement of Gazette contributions will be accepted. If you have not received a reply confirming acceptance of your email by the close of business on that day please phone 9372 7447.*

## Department of Finance and Services Tenders

### SUPPLIES AND SERVICES FOR THE PUBLIC SERVICE

Information in relation to the Department of Finance and Services proposed, current and awarded tenders is available on:

<http://www.tenders.nsw.gov.au>

*SEE the Government Gazette website at:*  
*<http://nsw.gov.au/gazette>*



# Government Gazette

OF THE STATE OF  
NEW SOUTH WALES

**Number 73**  
**Friday, 15 July 2011**

Published under authority by Government Advertising

## SPECIAL SUPPLEMENT

### STATE OWNED CORPORATIONS (PORTFOLIO MINISTER) AMENDMENT ORDER 2011

Pursuant to Section 20I of the State Owned Corporations Act 1989

I, BARRY O'FARRELL, Premier of the State of New South Wales, in pursuance of section 20I of the State Owned Corporations Act 1989, make the following Order.

Dated, this 15th day of July 2011.

BARRY O'FARRELL, M.P.,  
Premier

#### 1 Name of Order

This Order is the *State Owned Corporations (Portfolio Minister) Amendment Order 2011*.

#### 2 Commencement

This Order commences on the date on which it is published in the NSW Government Gazette.

#### 3 Amendment of earlier Order

*The State Owned Corporations (Portfolio Minister) Further Order 2010* is amended by omitting clause 4 and the Schedule.

ISSN 0155-6320

---

Authorised to be printed  
DENIS H. HELM, Government Printer.



# Government Gazette

OF THE STATE OF  
NEW SOUTH WALES

**Number 74**  
**Monday, 18 July 2011**

Published under authority by Government Advertising

## SPECIAL SUPPLEMENT

### FISHERIES MANAGEMENT ACT 1994

#### Section 183 – Quarantine Order

#### QX Disease

I, BRUCE CHRISTIE, Principal Director, Biosecurity, with the delegated authority of the Minister for Primary Industries and the Director General of the Department of Trade and Investment, Regional Infrastructure and Services pursuant to sections 227 and 228 of the Fisheries Management Act 1994 (“the Act”), do by this order:

- 1 pursuant to section 183 of the Act and section 43 (2) of the Interpretation Act 1987, repeal the Quarantine Order titled “Section 183 – Quarantine Order QX Disease” published in *New South Wales Government Gazette* No. 75 of 22 May 2009, at pages 2307-2308;
- 2 pursuant to section 183 of the Act:
  - (i) declare each the following estuaries to be a quarantine area (“the Quarantine Areas”) because of the presence or suspected presence of the declared disease marteiliosis (QX disease):
    - (a) Richmond River
    - (b) Clarence River
    - (c) Macleay River
    - (d) Hawkesbury River
    - (e) Georges River
    - (f) Tweed River
    - (g) Brunswick River
    - (h) Bellingen-Kalang River
  - (ii) prohibit the taking of oysters or the movement of cultivation equipment and/or infrastructure from the Quarantine Areas except under the following conditions:
    - (a) oyster cultivation equipment and infrastructure (eg. oyster sticks, trays, baskets) used in any of the Quarantine Areas must be dried for 30 days before use in any other NSW estuary.
    - (b) oysters, oyster cultivation equipment and infrastructure may be relocated between the Quarantine Areas but only in accordance with the Oyster Shipment Log Book System for the Movement of Oysters, Oyster Cultivation Equipment and Infrastructure which is detailed below in Schedule 1.
    - (c) oysters may be taken and culled in or adjacent to the Quarantine Areas or in accordance with a protocol approved by the Principal Director, Biosecurity.
  - (iii) exclude sections 185 and 186 of the Fisheries Management Act 1994 with respect to oysters taken from the Quarantine Areas or any part of the Quarantine Areas in accordance with this order (but only in relation to the declared disease marteiliosis (QX disease)).
  - (iv) require all holders of aquaculture permits within the Quarantine Areas to follow all directions of a fisheries officer made under section 183 (4) of the Act.

## SCHEDULE 1

## Oyster Shipment Logbook System for the Movement of Oysters, Oyster Cultivation Equipment and Infrastructure

- (1) All shipment of oysters, oyster cultivation equipment and infrastructure other than those within an estuary or those destined for direct sale for human consumption must be recorded in an Oyster Shipment Log Book prior to shipment.
- (2) Not less than 2 days prior to the shipment of a consignment of oysters, oyster cultivation equipment and infrastructure between estuaries, the shipping permit holder must contact the local District Fisheries Office and identify the shipper, the nature of the shipment and its destination and the Oyster Shipment Log Book shipment permit number (top right hand corner of the shipment sheet).
- (3) Prior to the shipment of oysters, oyster cultivation equipment and infrastructure, the shipping permit holder must record on all four (4) quadruplicate copies of the Oyster Shipment Log Book sheets, details of the destination (including interstate), quantity (bag equivalents) and form (trays, sticks, etc) of oysters to be shipped.
- (4) For each shipment of oysters, oyster cultivation equipment and infrastructure, the completed original white copy (copy 1) of the Oyster Shipment Log Book sheets must accompany the shipment and be retained by the receiving permit holder.
- (5) The Oyster Shipment Log Book or the original white copy (copy 1) of the Oyster Shipment Log Book that has accompanied a shipment, must be made available to a Fisheries Officer for inspection on demand.
- (6) The holder of an Oyster Shipment Log Book must at the end of each month in which a shipment has occurred, forward all blue copies (copy 3) for those shipments to NSW Department of Primary Industries Aquaculture Management at the address specified below.

Note: Oyster Shipment Log Books are available on application from NSW Department of Primary Industries Aquaculture Administration, Locked Bag 1, Nelson Bay NSW 2315 or by phoning (02) 4982 1232.

In this Schedule, a reference to an estuary in paragraph 2 (i) includes a reference to all creeks, rivers, lakes, lagoons and tributaries flowing into or from that estuary and any jetty, wharf, boat ramp or land used for aquaculture purposes in the immediate vicinity of the water.

This order is in force for a term of four years commencing on the date of publication of this order unless sooner amended or revoked.

Dated this 18th day of July 2011.

BRUCE CHRISTIE,  
Principal Director, Biosecurity,  
Department of Trade and Investment, Regional Infrastructure and Services

Note: In addition to complying with the terms of this order, the taking of oysters or the movement of oyster cultivation equipment and/or infrastructure must comply with the terms of any fishing closure made under section 8 and section 11 of the Fisheries Management Act 1994 including the fishing closure titled "QX Disease" of 11 July 2008 published in the *New South Wales Government Gazette* No. 87 of 11 July 2008, at page 6994-6996 as amended by the fishing closure titled "QX Disease" of 18 May 2009 published in the *New South Wales Government Gazette* No. 75 of 22 May 2009, at page 2307.

**PLANT DISEASES (FRUIT FLY OUTBREAK, MURRAY VALLEY HWY, STRATHMERTON) ORDER 2011**

under the Plant Diseases Act 1924

I, SATENDRA KUMAR, Director Plant Biosecurity of the Department of Trade and Investment, Regional Infrastructure and Services, with the delegated authority of the Minister for Primary Industries in pursuance of section 3A of the Plant Diseases Act 1924 (“the Act”), and in pursuance of section 4 of the Act being of the opinion that the importation, introduction or bringing of host fruit into specified portions of New South Wales is likely to introduce the pest Queensland fruit fly (*Bactrocera tryoni*) into specified portions of New South Wales, make the following Order regulating the importation, introduction or bringing of host fruit into specified portions of New South Wales.

**1 Name of Order**

This Order is the Plant Diseases (Fruit Fly Outbreak, Murray Valley Hwy, Strathmerton) Order 2011.

**2 Commencement**

This Order commences on the date it is published in the *NSW Government Gazette*.

**3 Interpretation**

(a) In this Order:

**approved treatment** means a treatment or schedule of treatments relevant to the type of host fruit or manner of harvest as specified in Schedule 6.

**APVMA** means the Australian Pesticides and Veterinary Medicines Authority.

**authorised person** means an inspector or a person authorised pursuant to section 11 (3) of the Act.

**certificate** means a Plant Health Certificate or a Plant Health Assurance Certificate.

**Certification Assurance Arrangement** means an arrangement approved by the Department which enables a business accredited under the arrangement to certify that certain quarantine requirements have been satisfied for the movement of host fruit to interstate and/or intrastate markets.

Note: An example of an approved Certification Assurance Arrangement is the Interstate Certification Assurance (ICA) Scheme.

**Department** means Industry and Investment, NSW – Primary Industries.

**free of broken skin** means the skin has no preharvest cracks, punctures, pulled stems or other breaks which penetrate through the skin and that have not healed with callus tissue.

**host fruit** means the fruit specified in Schedule 1, being fruit which is susceptible to infestation by Queensland fruit fly.

**lot** means a discrete quantity of fruit received from one grower at one time.

**Outbreak Area** means the portion of New South Wales described in Schedule 2.

**Outer Area** means the portion of New South Wales known as the NSW Fruit Fly Exclusion Zone, as specified in Proclamation P184 published in *NSW Government Gazette* No. 152 of 28 November 2008 at pages 11434 to 11435, excluding the Outbreak Area and the Suspension Area.

**Plant Health Assurance Certificate** means a certificate issued by a business accredited under a Certification Assurance Arrangement.

**Plant Health Certificate** means a certificate issued by an authorised person.

**Queensland fruit fly** means the pest *Bactrocera tryoni* (Froggatt).

**Suspension Area** means the portion of New South Wales described in Schedule 3.

**the Act** means the Plant Diseases Act 1924.

Note: **covering** or **package**, **inspector**, **occupier** and **owner** all have the same meaning as in the Act.

(b) In this Order, longitude and latitude coordinates are decimal degrees based upon the GDA 94 datum.

**4 Regulation of the movement of host fruit**

Pursuant to section 4 (1) of the Act the importation, introduction or bringing of host fruit into specified portions of New South Wales is regulated as follows:

(a) Host fruit that originates from or has moved through:

(i) the Outbreak Area must not be moved into the Suspension Area or the Outer Area;

(ii) the Suspension Area must not be moved into the Outer Area,

except for such movements as are specified in Schedule 5 and which comply with the relevant conditions of exception set out in Schedule 5; and

(b) The movement of any host fruit in accordance with Schedule 5 must be accompanied by a certificate:

(i) specifying the origin of the host fruit; and

(ii) in the case of a Plant Health Certificate, certifying that the host fruit has been treated in the manner specified in Schedule 6; and

(iii) in the case of a Plant Health Assurance Certificate, certifying that the host fruit originates from a property or facility which is owned or occupied by a business accredited under a Certification Assurance Arrangement.



**SCHEDULE 1 – Host fruit**

Abiu	Chilli	Lime	Persimmon
Acerola	Citron	Loganberry	Plum
Apple	Cumquat	Longan	Plumcot
Apricot	Custard Apple	Loquat	Pomegranate
Avocado	Date	Lychee	Prickly Pear
Babaco	Durian	Mandarin	Pummelo
Banana	Eggplant	Mango	Quince
Black Sapote	Feijoa	Mangosteen	Rambutan
Blackberry	Fig	Medlar	Raspberry
Blueberry	Granadilla	Miracle Fruit	Rollinia
Boysenberry	Grape	Mulberry	Santol
Brazil Cherry	Grapefruit	Nashi	Sapodilla
Breadfruit	Grumichama	Nectarine	Shaddock
Caimito (Star Apple)	Guava	Orange	Soursop
Cape Gooseberry	Hog Plum	Passionfruit	Sweetsop (Sugar Apple)
Capsicum	Jaboticaba	Pawpaw	Strawberry
Carambola (Starfruit)	Jackfruit	Peach	Tamarillo
Cashew Apple	Jew Plum	Peacharine	Tangelo
Casimiro (White Sapote)	Ju jube	Pear	Tomato
Cherimoya	Kiwifruit	Pepino	Wax jambu (Rose Apple)
Cherry	Lemon		

**SCHEDULE 2 – Outbreak Area**

The area within a 1.5 kilometre radius of the coordinates decimal degrees -35.92475 South and 145.47952 East, being the area within the 1.5 kilometre radius circle (broken line) in the map in Schedule 4.

**SCHEDULE 3 – Suspension Area**

The area within a 15 kilometre radius of coordinates decimal degrees -35.92475 South and 145.47952 East (excluding the Outbreak Area), being the area between the 1.5 kilometre radius circle (broken line) and the 15 kilometre radius circle (unbroken line) in the map in Schedule 4.

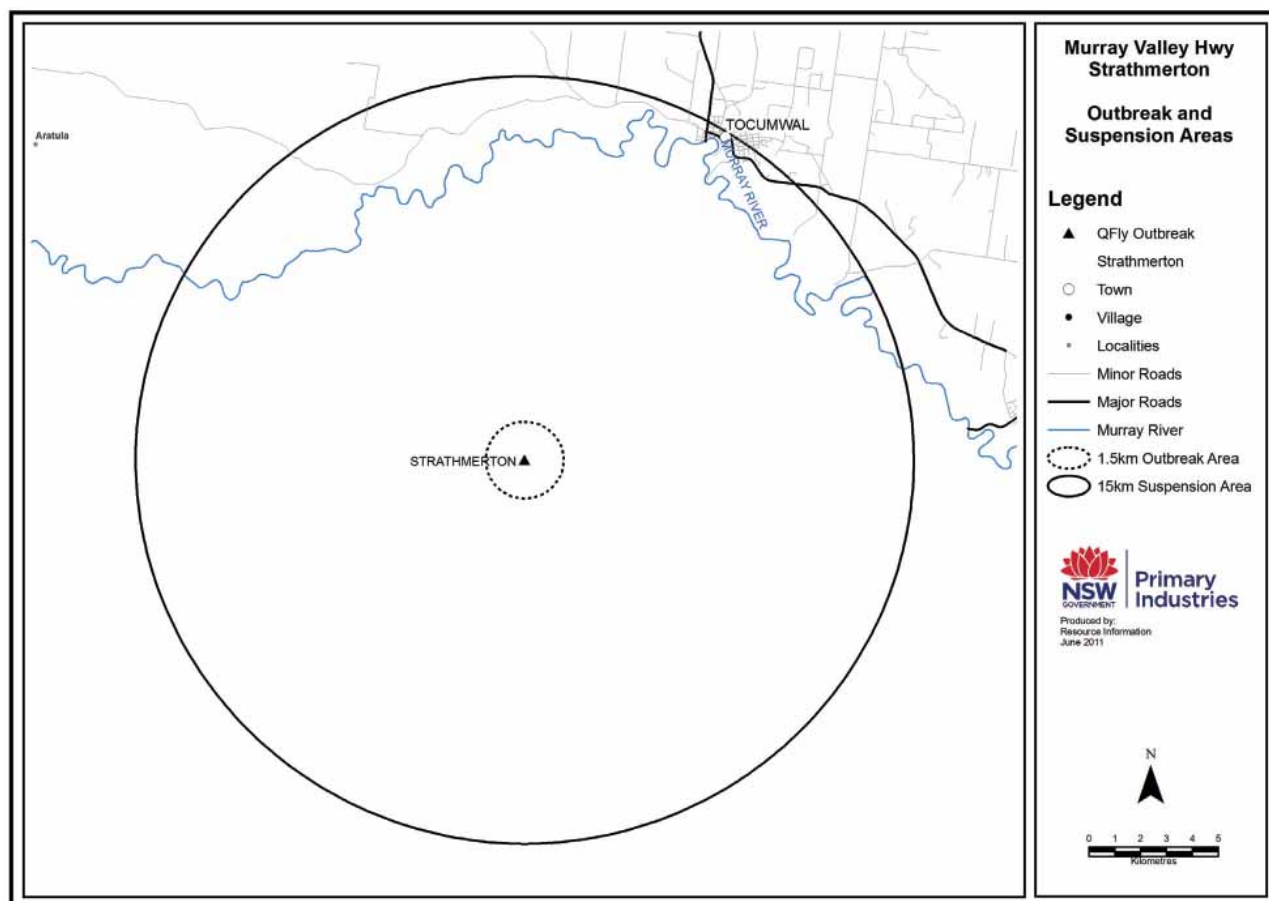
**SCHEDULE 4 – Map of the Murray Valley Hwy, Strathmerton Outbreak Area and Suspension Area**



**SCHEDULE 5 – Exceptions for movement of host fruit****Host fruit that has received an approved treatment**

1. Movement of host fruit that has received an approved treatment prior to movement, subject to the following conditions:
  - (a) The owner or occupier of the property or facility from which the host fruit originates must ensure that the host fruit remains under secure conditions from post harvest to the time of dispatch and transport, except when impractical during packing and grading activities; and
  - (b) Prior to movement, the owner or occupier of the property or facility from which the host fruit originates must ensure that:
    - (i) any used packaging or coverings containing host fruit are free of soil, plant residues and other organic matter; and
    - (ii) in the case of host fruit that has been consigned as a lot for the purpose of producing smaller packs of host fruit and has been repacked in smaller packs, the host fruit has been received, handled, stored and repacked under secure conditions which prevent infestation by Queensland fruit fly; and
    - (iii) any individual package contains only one kind of host fruit; and
    - (iv) all previous incorrect information displayed on the outer covering of the package is removed and the outer covering is legibly marked with the following information:
      - (A) the district of production; and
      - (B) the name, address, postcode and the State or Territory of both the grower and the packer; or where the business is sourcing from multiple growers, the name, address, postcode and the State or Territory of the packer; and
      - (C) a brief description of the contents of the package;or
  - (v) where the host fruit originates from a property or facility which is owned or occupied by a business accredited under a Certification Assurance Arrangement, the host fruit is packed, labelled and certified in accordance with any conditions prescribed in the Certification Assurance Arrangement.

**Untreated host fruit for processing**

2. Movement of untreated host fruit for processing, subject to the following conditions:
  - (a) The owner or occupier of the property or facility from which the host fruit originates must ensure that the host fruit remains under secure conditions from post harvest to the time of dispatch and transport, except when impractical during packing and grading activities; and
  - (b) Prior to movement, the owner or occupier of the property or facility from which the host fruit originates must ensure:
    - (i) all bins or containers and any vehicles to be used for the transportation of host fruit (“transport vehicle”) are free from all plant debris and soil prior to packing and loading; and
    - (ii) the host fruit is securely covered by a tarpaulin, shade cloth, bin cover or other covering or contained within the covered transport vehicle so as to prevent infestation by Queensland fruit fly and spillage during transportation; and
    - (iii) the host fruit must be loaded onto or into a transport vehicle on a hard surface and not within the orchard from which the host fruit was sourced; and
    - (iv) the transport vehicle is free of all soil and plant debris after loading; and
    - (v) the transport vehicle travels by the most direct route to the receiving processor; and
  - (c) The owner or occupier of the property or facility at which the host fruit is to be processed must ensure:
    - (i) the host fruit is processed within 24 hours of receipt; and
    - (ii) all measures to avoid spillage of host fruit are taken and where spillages occur, must be disposed of in a manner generally accepted as likely to prevent the spread of Queensland fruit fly; and
    - (iii) all processing wastes must be disinfested by heat or freezing or be buried.

**Outer Area host fruit on a direct journey through the Outbreak Area or Suspension Area into the Outer Area**

3. Movement of host fruit originating within the Outer Area and moving on a direct journey through the Outbreak Area or the Suspension Area into the Outer Area, subject to the following conditions:
  - (a) The owner or occupier of the property or facility from which the host fruit originates must ensure that the host fruit is securely transported by covering with a tarpaulin, shade cloth, bin cover or other covering or contained within the covered transport vehicle so as to prevent infestation by Queensland fruit fly and spillage during transportation.

**Untreated Suspension Area host fruit on a direct journey to an end destination having no restrictions on account of Queensland fruit fly**

4. Movement of host fruit originating within the Suspension Area and moving on a direct journey to an end destination which has no restrictions on account of Queensland fruit fly, subject to the following conditions:
  - (a) The owner or occupier of the property or facility from which the host fruit originates must ensure that the host fruit remains under secure conditions from post harvest to the time of dispatch and transport, except when impractical during packing and grading activities; and

- (b) Prior to movement, the owner or occupier of the property or facility from which the host fruit originates must ensure:
  - (i) all bins or containers and any vehicles to be used for the transportation of host fruit (“transport vehicle”) are free from all plant debris and soil prior to packing and loading; and
  - (ii) the host fruit must be loaded onto or into a transport vehicle on a hard surface and not within the orchard from which the host fruit was sourced; and
  - (iii) the transport vehicle is free of all soil and plant debris after loading; and
  - (iv) the host fruit is transported under secure conditions that include:
    - (A) unvented packages or vented packages with the vents secured with mesh with a maximum aperture of 1.6mm prior to dispatch; or
    - (B) shrink-wrapped and sealed as a palletised unit; or
    - (C) fully enclosed under tarpaulins, shade cloth, bin cover or other covering which provides a maximum aperture of 1.6mm,so as to prevent infestation by Queensland fruit fly and spillage during transportation; and
  - (v) the transport vehicle travels by the most direct route.

#### **SCHEDULE 6 – Approved treatments for host fruit**

##### **Preharvest Treatment and Inspection**

1. Tomatoes:
  - (a) treated preharvest with an application of dimethoate or fenthion or trichlorfon in accordance with all label directions for the control of Queensland fruit fly, and
  - (b) inspected postharvest at the rate of at least 1 package in every 100 or part thereof, and found free of fruit fly larvae and free of broken skin.
2. Capsicums and chillies:
  - (a) treated preharvest with an application of dimethoate in accordance with all label directions for the control of Queensland fruit fly, and
  - (b) inspected postharvest at the rate of at least 1 package in every 100 or part thereof, and found free of fruit fly larvae and free of broken skin.
3. Stonefruit:
  - (a) treated preharvest with an application of fenthion in accordance with all label directions for the control of Queensland fruit fly; and
  - (b) inspected postharvest at the rate of at least 1 package in every 100 or part thereof, and found free of fruit fly larvae and free of broken skin.
4. Table grapes:
  - (a) treated preharvest for the control of Queensland fruit fly, with a program of:
    - (i) bait sprays with an insecticide containing 0.24 g/L spinosad as the only active constituent in accordance with all label directions; or
    - (ii) bait sprays with an insecticide containing 1150 g/L maldison as the only active constituent in accordance with all label and APVMA permit (PER12359) directions; or
    - (iii) cover sprays using an insecticide containing 550 g/L fenthion as the only active constituent in accordance with all label and APVMA permit (PER11643) directions; and
  - (b) inspected postharvest where a sample of the fruit is inspected and found free of fruit fly larvae and free of broken skin.

##### **Postharvest Dimethoate Dip**

5. Any host fruit, excluding capsicum (hollow-fruited), chilli (hollow-fruited), cumquat and strawberries, treated with a postharvest dip using an insecticide containing 400 g/L dimethoate as its only active constituent in accordance with all label and APVMA permit (PER12074) directions; where dipping is the last treatment before packing except in the case of:
  - (a) Citrus, where a non-recovery gloss wax coating and or a compatible fungicide as specified on the label may be applied within 24 hours of treatment; and
  - (b) Pomefruit, where a non-recovery gloss wax and or a compatible fungicide as specified on the label may be applied within 3 hours of treatment.

##### **Postharvest Dimethoate Flood Spray**

6. Any host fruit, excluding cumquat, eggplant and strawberries, treated with a postharvest flood spray using an insecticide containing 400 g/L dimethoate as its only active constituent in accordance with all label and APVMA permit (PER12074) directions, where spraying is the last treatment before packing except in the case of:
  - (a) Citrus, where a non-recovery gloss wax coating and or a compatible fungicide as specified on the label may be applied within 24 hours of treatment; and

- (b) Pomefruit, where a non-recovery gloss wax coating and or compatible fungicide as specified on the label may be applied within 3 hours of treatment.

**Postharvest Methyl Bromide Fumigation**

7. Any host fruit fumigated postharvest with a fumigant containing 1000 g/kg methyl bromide as its only active constituent in accordance with all label and APVMA permit (PER10699) directions, at the following rates:
- (a) 10°C – 14.9°C at 48 g/m<sup>3</sup> for 2 hours; or
  - (b) 15°C – 20.9°C at 40 g/m<sup>3</sup> for 2 hours; or
  - (c) 21°C – 25.9°C at 32 g/m<sup>3</sup> for 2 hours; or
  - (d) 26°C – 31.9°C at 24 g/m<sup>3</sup> for 2 hours.

**Postharvest Cold Treatment**

8. Any appropriate host fruit treated postharvest at a temperature of:
- (a) 0°C ± 0.5°C for a minimum of 14 days; or
  - (b) 1°C – 3°C ± 0.5°C for a minimum of 16 days (Lemons minimum 14 days).

Dated this 18th day of July 2011.

SATENDRA KUMAR,  
Director, Plant Biosecurity,  
Department of Trade and Investment, Regional Infrastructure and Services

Note: The Department's reference is O-373

ISSN 0155-6320

---

Authorised to be printed  
DENIS H. HELM, Government Printer.



# *Government Gazette*

OF THE STATE OF  
NEW SOUTH WALES

**Number 75**  
**Tuesday, 19 July 2011**

Published under authority by Government Advertising

## **SPECIAL SUPPLEMENT**

### **ANIMAL DISEASES (EMERGENCY OUTBREAKS) ACT 1991**

#### **ORDER – Section 76**

Certification that an outbreak of the emergency animal disease Hendra virus exists in part of New South Wales

I, MARK I PATERSON, AO, Director General of the Department of Trade and Investment, Regional Infrastructure and Services, with the powers the Minister has delegated to me pursuant to section 67 of the Animal Diseases (Emergency Outbreaks) Act 1991 (“the Act”) and pursuant to section 76 of the Act, certify that an outbreak of the emergency animal disease Hendra virus exists:

1. in a premises in the vicinity of Wollongbar which was quarantined pursuant to section 35 of the Act on 30 June 2011;  
and
2. in a premises in the vicinity of Macksville which was quarantined pursuant to section 35 of the Act on 7 July 2011,  
in New South Wales.

Dated this 16th day of July 2011.

MARK I PATERSON, AO,  
Director General,  
Department of Trade and Investment, Regional Infrastructure and Services

ISSN 0155-6320

---

Authorised to be printed  
DENIS H. HELM, Government Printer.



# *Government Gazette*

OF THE STATE OF  
NEW SOUTH WALES

**Number 76**  
**Friday, 22 July 2011**

Published under authority by Government Advertising

## LEGISLATION

### Online notification of the making of statutory instruments

Week beginning 11 July 2011

THE following instruments were officially notified on the NSW legislation website ([www.legislation.nsw.gov.au](http://www.legislation.nsw.gov.au)) on the dates indicated:

#### Regulations and other statutory instruments

[Australian Jockey and Sydney Turf Clubs Merger \(Repeal\) Proclamation 2011 \(2011-370\)](#) — published LW 15 July 2011

[Child Protection \(Offenders Prohibition Orders\) Amendment \(Corresponding Prohibition Orders\) Regulation 2011 \(2011-371\)](#) — published LW 15 July 2011

[Industrial Relations \(General\) Amendment \(Fees\) Regulation 2011 \(2011-366\)](#) — published LW 15 July 2011

[Public Finance and Audit Amendment \(Parliamentary Contributory Superannuation Fund\) Regulation 2011 \(2011-364\)](#) — published LW 14 July 2011

[Public Finance and Audit Amendment \(Payment of Accounts\) Regulation 2011 \(2011-365\)](#) — published LW 14 July 2011

[Subordinate Legislation \(Postponement of Repeal\) Order 2011 \(2011-367\)](#) — published LW 15 July 2011

[Western Sydney Parklands Amendment Order 2011 \(2011-368\)](#) — published LW 15 July 2011

#### Environmental Planning Instruments

[Standard Instrument \(Local Environmental Plans\) Amendment \(Miscellaneous\) Order 2011 \(2011-362\)](#) — published LW 13 July 2011

[State Environmental Planning Policy \(SEPP 53 Transitional Provisions\) 2011 \(2011-369\)](#) — published LW 15 July 2011

[State Environmental Planning Policy Amendment \(Standard Instrument\) 2011 \(2011-363\)](#) — published LW 13 July 2011



## Other Legislation

### THREATENED SPECIES CONSERVATION ACT 1995

#### ERRATUM

THE Notice of Determination under the Threatened Species Conservation Act 1995 published in the *New South Wales Government Gazette* of 8 July 2011 on pages 4835 to 4838 was incomplete. The Final Determination for Sandhill Pine Woodland in the Riverina, Murray-Darling Depression and NSW South Western Slopes Bioregions was not included. The Final Determination is now published following this erratum. The gazettal date remains 8 July 2011.

Determination to make a minor amendment to Part 3 of Schedule 1 of the Threatened Species Conservation Act

THE Scientific Committee, established by the Threatened Species Conservation Act has made a Determination to make a minor amendment to Part 3 of Schedule 1 (Endangered ecological communities) of the Act by inserting the Sandhill Pine Woodland in the Riverina, Murray-Darling Depression and NSW South Western Slopes bioregions (as described in the determination of the Scientific Committee under Division 5 Part 2) and as a consequence to omit reference to the Sandhill Pine Woodland in the Riverina, Murray-Darling Depression and NSW South Western Slopes bioregions (as described in the final determination to list the ecological community) which was published on pages 2509 to 2517 in the *NSW Government Gazette* No. 37 dated 28 March 2008. Minor amendments to the Schedules are provided for by Division 5 of Part 2 of the Act.

The Scientific Committee is of the opinion that the amendment is necessary or desirable to correct minor errors or omissions in the Determination in relation to the Thackway and Cresswell (1995) reference.

The Scientific Committee has found that:

1. Sandhill Pine Woodland in the Riverina, Murray-Darling Depression and NSW South Western Slopes bioregions is the name given to the ecological community dominated by *Callitris glaucophylla*, that typically occupies red-brown loamy sands with alkaline sub-soils on the alluvial plain of the Murray River and its tributaries, and on parts of the sandplain in south-western NSW. In the Riverina bioregion and the far south-western portion of the NSW South Western Slopes bioregion, the community is typically associated with prior streams and aeolian source-bordering dunes, which are scattered within an extensive alluvial clay plain dominated by chenopod shrublands. In the Murray-Darling Depression bioregion, the community occurs as scattered patches on sandhills and lunettes within an extensive aeolian sandplain dominated by woodlands of mallee eucalypts or *belah*. Bioregions are defined in Thackway and Cresswell (1995). Sandhill Pine Woodland is characterised by the assemblage of species listed in paragraph 2 and typically comprises an open tree canopy with a sometimes sparse, but highly variable ground layer dominated by grasses and herbs, sometimes with scattered shrubs and/or small trees. The structure and species composition of the community varies depending on disturbance history and temporal variability in rainfall.

2. Sandhill Pine Woodland is characterised by the following assemblage of species:

<i>Actinobole uliginosum</i>	<i>Allocasuarina luehmannii</i>
<i>Atriplex semibaccata</i>	<i>Austrodanthonia caespitosa</i>
<i>Austrodanthonia setacea</i>	<i>Austrostipa nodosa</i>
<i>Austrostipa scabra</i>	<i>Boerhavia dominii</i>
<i>Callitris glaucophylla</i>	<i>Cotula australis</i>
<i>Crassula colorata</i>	<i>Crassula decumbens</i> var. <i>decumbens</i>
<i>Crassula sieberiana</i>	<i>Einadia nutans</i>
<i>Enteropogon acicularis</i>	<i>Erodium crinitum</i>
<i>Glycine clandestina</i>	<i>Maireana enchylaenoides</i>
<i>Oxalis perennans</i>	<i>Panicum effusum</i>
<i>Paspalidium constrictum</i>	<i>Salsola tragus</i>
<i>Senecio quadridentatus</i>	<i>Sida corrugata</i>
<i>Stuartina muelleri</i>	<i>Wahlenbergia graniticola</i>

A large number of infrequently recorded species also characterise the community. These include:

<i>Acacia melvillei</i>	<i>Acacia oswaldii</i>
<i>Acacia victoriae</i> subsp. <i>arida</i>	<i>Alectryon oleifolius</i> subsp. <i>canescens</i>
<i>Calandrinia eremaea</i>	<i>Callitris gracilis</i> subsp. <i>murrayensis</i>
<i>Dissocarpus paradoxus</i>	<i>Dodonaea viscosa</i> subsp. <i>angustissima</i>
<i>Enchylaena tomentosa</i>	<i>Eremophila longifolia</i>
<i>Geijera parviflora</i>	<i>Hakea leucoptera</i> subsp. <i>leucoptera</i>
<i>Hakea tephrosperma</i>	<i>Maireana pyramidata</i>
<i>Myoporum platycarpum</i> subsp. <i>platycarpum</i>	<i>Pittosporum angustifolium</i>
<i>Rhagodia spinescens</i>	<i>Sclerolaena obliquicuspis</i>
<i>Wahlenbergia gracilentia</i>	

3. The total species list of the community is larger than that given above, with many species present in only one or two sites or in low abundance. The species composition of a site will be influenced by the size of the site, recent rainfall or drought conditions and by its disturbance (including grazing, land clearing and fire) history. The number and relative abundance of species will change with time since fire, and may also change in response to changes in fire frequency or grazing regime. At any one time, above-ground individuals of some species may be absent, but the species may be represented below ground in soil seed banks or as dormant structures such as bulbs, corms, rhizomes, rootstocks or lignotubers. The list of species given above is mainly of vascular plant species, however the community also includes micro-organisms, fungi, cryptogamic plants and both vertebrate and invertebrate faunas. These components of the community are poorly documented.
4. Sandhill Pine Woodland is characterised by an open tree stratum, which may be reduced to isolated individuals or may be absent as a result of past clearing. The tree layer is dominated by *Callitris glaucophylla* (White Cypress Pine), either in pure stands or with a range of other less abundant trees or tall shrubs. These may include *Acacia melvillei*, *A. oswaldii*, *Allocasuarina luehmannii* (Buloke), *Callitris gracilis* subsp. *murrayensis* (Slender Cypress Pine), *Hakea leucomera* (Needlewood), *H. tephrosperma* (Hooked Needlewood), *Myoporum platycarpum* (Sugarwood) and *Pittosporum angustifolium* (Berrigan). A scattered shrub layer is sometimes present and may include *Dodonaea viscosa* subsp. *angustifolia*, *Enchylaena tomentosa* (Ruby Saltbush), *Sclerolaena muricata* (Black Rolypoly) and/or *Maireana enchylaenoides* (bluebush). The groundcover is highly variable in structure and composition. It may be sparse or more continuous, depending on the history of disturbance, grazing and rainfall events. It comprises grasses, such as *Austrodanthonia caespitosa* (Ringed Wallaby Grass), *A. setacea* (Small-flowered Wallaby Grass), *Austrostipa nodosa* (a speargrass), *A. scabra* (Rough Speargrass), *Enteropogon acicularis* (Curly Windmill Grass), *Panicum effusum* and *Paspalidium constrictum*; and forbs including *Atriplex semibaccata* (Creeping Saltbush), *Einadia nutans* (Climbing Saltbush), *Erodium crinatum* (Blue Storksbill), *Oxalis perennans*, *Sida corrugata* (Corrugated Sida) and *Wahlenbergia* spp. (bluebells). The structure of the community varies depending on past and current disturbances, particularly clearing, logging, grazing and soil erosion.
5. Sandhill Pine Woodland shares a number of species with another endangered ecological community listed under the Threatened Species Conservation Act 1995: *Allocasuarina luehmannii* Woodland in the Riverina and Murray-Darling Depression bioregions. These two ecological communities inhabit similar soils and landforms and have similar geographic distributions. They may be distinguished on the basis of the relative abundance of their tree species and subtle differences in composition of their understorey. When tree abundance is assessed at hectare scales, *Callitris glaucophylla* is the most abundant tree species in Sandhill Pine Woodland, whereas in *Allocasuarina luehmannii* Woodland, *A. luehmannii* is the most abundant tree species. Differences in understorey composition are likely to be obscured as a result of the history of heavy disturbance throughout both communities. Vegetation with characteristics that are intermediate between Sandhill Pine Woodland and *Allocasuarina luehmannii* Woodland are covered collectively under the two Determinations.
6. A number of vegetation surveys and mapping studies have been carried out in regions within which Sandhill Pine Woodland occurs. The community includes: 'Callitris glaucophylla Woodland' (Community 36) and 'Dodonaea viscosa – Callitris preissii Shrubland' (Community 37) of Smith and Smith (1990); 'Mixed Woodland, Callitris Woodland' (a subunit of map units 4 and 11) of Fox (1991); 'Callitris Mixed Woodland' (map unit 16) of Scott (1992), Porteners (1993) and Porteners et al. (1997); 'Prior Stream Remnant Woodland' (Map unit 27) of Porteners (1993); 'Callitris glaucophylla open-woodland' (Community 1c) of Westbrooke and Miller (1995) and Westbrooke et al. (1998), and 'Callitris glaucophylla low open-woodland' (Community 4) of Morcom and Westbrooke (1990); 'Thyridolepis mitchelliana – Themeda australis understorey remnants in open woodland' (Community 2) of Benson et al. (1997); 'Callitris Mixed Woodland' (map units 1,2,3 & 6) of Stafford and Eldridge (2000); Callitris, Yellow Box, Western Grey Box, Needlewood, Buloke (map unit 53) and Callitris Mixed Woodland (map unit 55) of Roberts and Roberts (2001); Source Bordering Sands Woodland (Community 6) of White et al. (2002); *Callitris glaucophylla* ± *Allocasuarina luehmannii* ± *Alectryon oleifolius* Woodland on Sandy Rises (map unit ALP017) of Horner et al. (2002); and 'Pine-Oak Woodlands on Alluvial Dunes and Plains' (map unit ALP017) and 'Pine Woodlands on Dunes of the Murray Floodplain' (Map Unit FLP008) of McNellie et al. (2005). A review and classification of vegetation in western New South Wales (Benson et al. 2006) described four communities referable to Sandhill Pine Woodland of the Riverina, Murray-Darling Depression and NSW South Western Slopes bioregions: 'Cypress Pine woodland of source-bordering dunes mainly on the Murray River floodplain' (Community 19); 'Slender Cypress Pine – Sugarwood – Western Rosewood open woodland on sandy rises of the semi-arid (warm) and arid climate zones' (Community 21); 'White Cypress Pine open woodland of sand plains, prior streams and dunes mainly of the semi-arid (warm) climate zone' (Community 28); and 'White Cypress Pine-Drooping Sheoak grassy open woodland of the Riverine Plain' (Community 48). Sandhill Pine Woodland belongs to the Riverine Sandhill Woodlands vegetation class of Keith (2004).
7. Sandhill Pine Woodland has been recorded in the far south-western portion of the NSW South Western Slopes bioregion near Urana, extending through the Riverina bioregion, from the Urana – Narranderra district in the east, into the southern part of the Murray-Darling Depression bioregion, as far west as the South Australian border. It is currently known from the Balranald, Berrigan, Carrathool, Central Darling, Conargo, Corowa, Deniliquin, Hay, Murray, Narranderra, Urana, Wakool and Wentworth Local Government Areas, but may occur elsewhere in the Riverina, Murray-Darling Depression and NSW South Western Slopes bioregions sensu Thackway and Cresswell (1995). Throughout its distribution, the community occurs in relatively small patches, typically on red-brown sandy loams. In the Riverina and NSW South Western Slopes bioregions, these soils are associated with the beds of prior streams or source-bordering dunes adjacent to streams and lake beds, which are restricted and distinctive landforms on the extensive riverine plain. Further west,

in the Murray-Darling Depression Bioregion, the community occurs on lunettes associated with dry lake beds, and as patches within a mosaic of vegetation types on extensive sandplains.

8. Vegetation mapping studies cited in Paragraph 6 allow the remaining area of Sandhill Pine Woodland to be estimated in various parts of its geographic distribution. Mapping by botanists from the National Herbarium of NSW (Fox 1992, Scott 1993, Porteners 1993, Porteners *et al.* 1997) covers the majority of the geographic distribution of the community, which includes map units 16 and 27 (see paragraph 6). These maps show that map units 16 and 27 have a combined extant area of approximately 85 000 ha, with an additional 86 000 ha estimated to have been cleared or degraded to 'highly disturbed' open areas, and a further 35 000 ha mapped as 'scattered trees' (Porteners 1993). Additional areas of these vegetation types occur as unmapped patches within mosaics containing other vegetation types. There are also additional areas of Sandhill Pine Woodland to the east of the National Herbarium study area. Mapping by White *et al.* (2002) shows approximately 10 000 ha of vegetation (Community 6) referable to Sandhill Pine Woodland in this area. The Deniliquin 1:250 000 map sheet is within the total area surveyed by Fox (1992), Scott (1993), Porteners (1993) and Porteners *et al.* (1997). The Deniliquin sheet includes approximately 28 000 ha of the total 85 000 ha of map units 16 and 27, 11 000 ha of the total 35 000 ha of these units mapped as scattered trees and 68 000 ha of the total 86 000 ha of map units 16 and 27 estimated to have been cleared (Porteners 1993). More recent mapping on the Deniliquin 1:250 000 map sheet (McNellie *et al.* 2005) shows approximately 13 000 ha of map units referable to Sandhill Pine Woodland (ALP017 and FLP008). The smaller area of mapped vegetation referable to extant Sandhill Pine Woodland by McNellie *et al.* (2005) than by Porteners (1993) may be partly due to a more narrow interpretation of pine-dominated woodlands by the former authors, but may also reflect a decline in area of the community.
9. Sandhill Pine Woodland has undergone a large reduction in its geographic distribution as a consequence of clearing for cropping and pasture improvement (Grant 1989, Smith and Smith 1990, Scott 1992, Porteners 1993, Benson *et al.* 2006). This has occurred within a time span appropriate to the life cycle of the dominant species of the community, with much of the clearing taking place between 1880 and 1910 (Grant 1989). Some clearing for cereals and irrigated agriculture has occurred later in the twentieth century (DEC *in litt.*). A recent synthesis of available map data indicates that the distribution of this community has been reduced by 40 – 75 % (Mackenzie and Keith 2007a). Fragmentation of the remaining stands is likely to have resulted in a large reduction in the ecological function of the community due to the small population sizes of many constituent species, enhanced risks from environmental stochasticity, disruption to pollination and dispersal of fruits or seeds, and likely reductions in the genetic diversity of isolated populations (Young *et al.* 1996, Young & Clarke 2000). The geographic distribution of the community continues to decline as a consequence of small-scale clearing (Sluiter *et al.* 1997). 'Clearing of native vegetation' is listed as a Key Threatening Process under the Threatened Species Conservation Act 1995.
10. Most of the stands of Sandhill Pine Woodland that have escaped broad-scale clearing have been maintained as sources of timber, either in state forests or on private land. Logging of cypress pines for construction of fences and buildings has resulted in significant changes in the structure of vegetation in these remnants, indicating a large reduction in the ecological function of Sandhill Pine Woodland. As a consequence, many contemporary stands lack large old trees and, where tree recruitment has been limited by grazing, trees in other size classes may have been reduced in density or may have been eliminated altogether. Conversely, abundant regeneration of *C. glaucophylla* has occurred after logging at some sites when there has been a temporary reduction in numbers of livestock, feral rabbits and goats. This results in relatively dense even-aged stands of trees that have yet to attain the mature structure of the community. The structure of these dense even-aged stands contrasts markedly with that of some remnants in pastures, in which large senescent trees are the only remaining size class of trees present, as a result of the continual removal of regeneration by grazing animals (Mackenzie and Keith 2007b).
11. Most of the remaining stands of Sandhill Pine Woodland are degraded by overgrazing, which has resulted in simplification of community structure, changes in species composition, invasion of weeds and soil erosion (Stafford and Eldridge 2000). Overgrazing by domestic livestock and feral herbivores, including rabbits and goats, has resulted in a scarcity of woody understorey plants and a lack of regeneration of palatable trees and shrubs (Scott 1992, Porteners 1993, Benson *et al.* 2006). Consequently, senescent trees are not replaced with new individuals and there is a prolonged trend of stand degeneration. This is particularly evident in stands of Sandhill Pine Woodland in the western areas of its distribution in the Murray-Darling Depression bioregion (Scott 1992, Porteners *et al.* 1997, Mackenzie and Keith 2007b). Overgrazing also reduces structural complexity, plant species diversity and habitat suitability for vertebrate fauna of the community. The sandy-textured soils of Sandhill Pine Woodland are particularly sensitive to erosion when de-stabilised as a result of trampling by hooved animals and burrowing by rabbits (Semple 1987, Eldridge 1998, Eldridge and Greene 1994). These impacts are exacerbated under drought conditions. Lunettes that support Sandhill Pine Woodland are particularly vulnerable to erosion after overgrazing because their relatively steep slopes predispose them to erosion by water during and after rainfall events, as well as by wind. Collectively, the processes associated with overgrazing have resulted in a large reduction in the ecological function of the community. 'Competition and grazing by the feral European Rabbit, *Oryctolagus cuniculus*' and 'Competition and habitat degradation by Feral Goats, *Capra hircus*' are listed as Key Threatening Processes under the Threatened Species Conservation Act 1995.
12. Fragmentation, grazing and small-scale physical disturbance have resulted in weed invasion throughout the distribution of Sandhill Pine Woodland, which continues to threaten the ecological function of the community. Principal weed species include:

*Arctotheca calendula*  
*Avena* spp.  
*Bromus rubens*

Capeweed  
 Wild Oats  
 Red Brome

<i>Citrellus lanatus</i> var <i>lanatus</i>	Wild Melon
<i>Echium plantagineum</i>	Paterson's Curse
<i>Erodium cicutarium</i>	Common Storksbill
<i>Heliotropium</i> spp.	Heliotropes
<i>Hordeum leporinum</i>	Barley Grass
<i>Hypochaeris glabra</i>	Cat's Ear
<i>Lolium</i> spp.	Ryegrasses
<i>Lycium ferocissimum</i>	African Boxthorn
<i>Marrubium vulgare</i>	White Horehound
<i>Medicago</i> spp.	Medics
<i>Mesembryanthemum crystallinum</i>	Common Iceplant
<i>Pentaschistis airoides</i>	False Hairgrass
<i>Salvia verbenacea</i>	Wild Sage
<i>Schismus barbatus</i>	Arabian Grass
<i>Sonchus oleraceus</i>	Common Sowthistle
<i>Tribulus terrestris</i>	Caltrop
<i>Trifolium arvense</i>	Haresfoot Clover
<i>Vulpia myuros</i> forma <i>megallura</i>	Rat's Tail Fescue

13. Examples of Sandhill Pine Woodland have been recorded from Kalyarr, Mallee Cliffs, Mungo, Oolambeyan and Willandra National Parks, and Tarawi Nature Reserve (Morcom and Westbrooke 1990, Westbrooke and Miller 1995, Roberts and Roberts 2001, Porteners 1998, Benson *et al.* 2006). However, some of these reserves contain only a few hectares of the community, and all exhibit signs of degradation associated with past land uses and the continuing impacts of feral herbivores. Examples of Sandhill Pine Woodland with a diverse and healthy understorey that retain its native shrub component and contain a low abundance and diversity of weed species, are extremely rare in the region (Stafford and Eldridge 2000, DEC *in litt.*).
14. Sandhill Pine Woodland of the Riverina, Murray-Darling and NSW South Western Slopes bioregions is not eligible to be listed as a critically endangered ecological community.
15. Sandhill Pine Woodland of the Riverina, Murray-Darling Depression and NSW South Western Slopes bioregions is eligible to be listed as an endangered ecological community as, in the opinion of the Scientific Committee, it is facing a very high risk of extinction in New South Wales in the near future, as determined in accordance with the following criteria as prescribed by the Threatened Species Conservation Regulation 2002:

#### Clause 25

The ecological community has undergone, is observed, estimated, inferred or reasonably suspected to have undergone or is likely to undergo within a time span appropriate to the life cycle and habitat characteristics of its component species:

- (b) a large reduction in geographic distribution.

#### Clause 27

The ecological community has undergone, is observed, estimated, inferred or reasonably suspected to have undergone or is likely to undergo within a time span appropriate to the life cycle and habitat characteristics of its component species:

- (b) a large reduction in ecological function,
- as indicated by any of the following:
- (d) change in community structure
  - (e) change in species composition
  - (f) disruption of ecological processes
  - (g) invasion and establishment of exotic species
  - (h) degradation of habitat
  - (i) fragmentation of habitat

Dr RICHARD MAJOR,  
Chairperson,  
Scientific Committee

#### References

- Benson JS, Ashby EM, Porteners MF (1997) The native grasslands of the Riverine Plain, New South Wales. *Cunninghamia* **5**, 1-48.
- Benson JS, Allen CB, Togher C, Lemmon J (2006) New South Wales vegetation classification and assessment. Part 1 Plant communities of the NSW western plains. *Cunninghamia* **9**, 383-450.
- Eldridge, D.J. (1998). Trampling of microphytic crusts on calcareous soils and its impact on erosion under rain impacted flow. *Catena* **33**, 221-239



- Eldridge, D.J. and Greene, R.S.B. (1994). Assessment of sediment yield from a semi-arid red earth with varying cover of cryptogams. *Journal of Arid Environments* 26, 221-232.
- Horner G, McNellie M, Nott TA, Vanzella B, Scleibs M, Kordas GS, Tuner B, Hudspith TJ (2002) 'Native vegetation map report series No. 2. Dry lake, Oxley, Hay, One Tree, Moggumbill and Gunbar 1:100 000 map sheets.' NSW Department of Land and Water Conservation, Parramatta.
- Keith DA (2004) 'Ocean shores to desert dunes: the native vegetation of New South Wales and the ACT.' NSW Department of Environment and Conservation, Sydney.
- Mackenzie B, Keith DA (2007a) Assessment of Woodland Assemblages dominated by *Callitris* for listing as a threatened ecological community under the Threatened Species Conservation Act. Report to the NSW Scientific Committee.
- Mackenzie B, Keith DA (2007b) Field Reconnaissance of Sandhill Pine Woodland sites in Western NSW: Supplementary Report to the NSW Scientific Committee. Report to the NSW Scientific Committee.
- McNellie M, Horner G, Nott TA, Vanzella B, Scleibs M, Kordas GS, Tuner B, Hudspith TJ (2005) 'Native vegetation map series. Deniliquin 1:250 000 map sheet.' NSW Department of Natural Resources, Parramatta.
- Morcom L, Westbrooke M (1990) The vegetation of Mallee Cliffs National Park. *Cunninghamia* 2, 147-166.
- Porteners MF (1993) Natural vegetation of the Hay Plain: Booligal-Hay and Deniliquin-Bendigo 1:250 000 maps. *Cunninghamia* 3, 1-122.
- Porteners M (1998) 'Tarawi Nature Reserve Threatened Plants Survey.' Report to NSW National Parks and Wildlife Service, Buronga.
- Porteners MF, Ashby EM, Benson JS (1997) The natural vegetation of the Pooncarie 1:250 000 map. *Cunninghamia* 5, 139-231.
- Roberts I, Roberts J (2001) Plains-wanderer (*Pedionomus torquatus*) 'Habitat Mapping including Woody Vegetation and other Landscape Features. Riverina Plains, NSW.' Report to NSW National Parks and Wildlife Service, Griffith.
- Scott JA (1992) The natural vegetation of the Balranald-Swan Hill area. *Cunninghamia* 2, 597-654.
- Semple WS (1987) Prior streams and Queel Queel gums – regeneration areas revisited. *Journal of Soil Conservation* 43, 38-43.
- Sivertsen D, Metcalfe L (1995) Natural vegetation of the southern wheat-belt (Forbes and Cargelligo 1:250 000 map sheets). *Cunninghamia* 4(1), 103-128.
- Sluiter IRK, Minchin PR, Jaensch SC (1997) 'The Buloke and Pine Woodlands of semi-arid and dry sub-humid Victoria and nearby areas.' Ogyris Ecological Research Report No. 97/02
- Smith P, Smith J (1990) 'Riparian vegetation of the River Murray.' (Murray Darling Basin Commission: Canberra).
- Stafford MJ, Eldridge DJ (2000) Vegetation, soils and management of 'Zara': a sandhill remnant on the Riverine Plain. *Cunninghamia* 6, 717-746.
- Thackway R, Cresswell ID (1995) (eds) 'An interim biogeographic regionalisation of Australia: a framework for establishing the national system of reserves.' (Version 4.0 Australian Nature Conservation Agency: Canberra).
- White MD, Muir AM, Webster R (2002) *The reconstructed distribution of indigenous vegetation types across the NSW Riverina*. Unpublished report to the NSW National Parks and Wildlife Service.
- Young A, Boyle T, Brown A (1996) The population genetic consequences of habitat fragmentation for plants. *Trends in Ecology and Evolution* 11, 413-418.
- Young A, Clarke G (2000) Genetics, demography and the viability of fragmented populations. (Cambridge University Press: Cambridge)
-

**OFFICIAL NOTICES****Appointments****PARLIAMENTARY REMUNERATION ACT 1989**

## Appointment

## Parliamentary Remuneration Tribunal

PURSUANT to the provisions of Clause 1 of Schedule 2 of the Parliamentary Remuneration Act 1989, I have determined to re-appoint the Honourable Justice Conrad Gerard STAFF as the Parliamentary Remuneration Tribunal for a further 3 year term commencing on 28 August 2011 and expiring on 28 August 2014.

The Honourable Justice R. P. BOLAND,  
President,  
Industrial Relations Commission of New South Wales

**STATUTORY AND OTHER OFFICES  
REMUNERATION ACT 1975**

## Appointment

## Statutory and Other Offices Remuneration Tribunal

HER Excellency the Governor, with the advice of the Executive Council, and in pursuance of section 6 (2) of the Statutory and Other Offices Remuneration Act 1975, has approved the appointment of Ms Helen Irwin WRIGHT, as the Statutory and Other Offices Remuneration Tribunal for the period 13 July 2011 up to and including 12 July 2014.

BARRY O'FARRELL, M.P.,  
Premier

## Department of Primary Industries

### STOCK DISEASES ACT 1923

Proclamation No. 571

Proclamation to Declare that Certain Diseases in Stock  
are Subject to Provisions of the Act

HER Excellency Professor Marie Bashir, Companion of the Order of Australia, Commander of the Royal Victorian Order, Governor of the State of New South Wales in the Commonwealth of Australia.

I, Professor Marie Bashir, A.C., C.V.O., Governor of the State of New South Wales, with the advice of the Executive Council:

1. pursuant to section 3 (2) (a) of the Stock Diseases Act 1923 ('the Act'), revoke Proclamation No. 570 published in *New South Wales Government Gazette* No. 43 of 3 May 2011 at pages 2735-2738 and any Proclamation revived as a result of its revocation; and
2. pursuant to section 4 (a) of the Act declare that the diseases specified in Column 1 of the Schedule, being diseases in stock, are diseases in respect of which the provisions of the Act or only such provisions of the Act as are specified in Column 2 of the Schedule, apply.

### SCHEDULE

Diseases in stock recognised as exotic

<i>Column 1</i>	<i>Column 2</i>
Acariasis Tracheal Mite ( <i>Acaraspis woodi</i> )	
African horse sickness	
Africanised honeybees	
African swine fever	
Asian honeybee ( <i>Apis cerana</i> )	
Aujeszky's disease	
Australian bat lyssavirus	
Avian influenza	
Bluetongue	
Borna disease	
Bovine tuberculosis due to <i>Mycobacterium bovis</i>	
Bovine Virus Diarrhoea Type 2	
Braula fly (Bee louse, <i>Braula coeca</i> )	
Brucellosis ( <i>B. Abortus</i> , <i>B. suis</i> , <i>B. canis</i> and <i>B. melitensis</i> )	
Camelpox	
Chagas' disease ( <i>T. cruzi</i> )	
Classical swine fever	
Contagious agalactia	
Contagious bovine pleuropneumonia	
Contagious caprine pleuropneumonia	
Contagious equine metritis	
Crimean Congo Haemorrhagic Fever	

<i>Column 1</i>	<i>Column 2</i>
Devil Facial Tumour Disease	
Dourine	
Duck virus enteritis (duck plague)	Only section 9
Duck virus hepatitis	Only section 9
Dwarf honeybee ( <i>Apis florum</i> )	
East Coast fever and Mediterranean theileriosis	
Encephalitides (tick borne)	
Enzootic abortion of ewes	
Epizootic haemorrhagic disease (clinical disease)	
Epizootic lymphangitis	
Equine encephalomyelitis ( <i>Eastern, Western and Venezuelan</i> )	
Equine encephalosis	
Equine herpes – virus 1 (neurological strain)	
Equine influenza	
Equine piroplasmiasis ( <i>Babesia equi</i> , <i>Babesia caballi</i> and <i>Theileria equi</i> )	
Foot and mouth disease	
Fowl typhoid ( <i>Salmonella gallinarum</i> )	
Getah virus infection	
Giant honeybee ( <i>Apis dorsata</i> )	
Glanders	
Haemorrhagic septicaemia	
Heartwater	
Hendra virus infection	
Infectious bursal disease (hypervirulent and exotic antigenic variant forms)	
Influenza pandemic (H1N1) 2009	Only section 9
Japanese encephalitis	
Jembrana disease	
Leishmaniasis of any species	
Louping ill	Only section 9
Lumpy skin disease	
Maedi-visna	
Malignant catarrhal fever (wildebeest associated)	
Menangle virus infection	
Nairobi sheep disease	
Newcastle disease	
Nipah virus infection	
Peste des petits ruminants	
Porcine cysticercosis ( <i>C. cellulosae</i> )	Only section 9



Column 1	Column 2
Porcine enterovirus encephalomyelitis ( <i>Teschen</i> )	
Porcine reproductive and respiratory syndrome	
Post-weaning multi-systemic wasting syndrome	
Potomac fever	
Pulmonary adenomatosis (Jaagsiekte)	
Rabies	
Rift Valley fever	
Rinderpest	
Salmonellosis ( <i>S. abortus equi</i> )	
Salmonellosis ( <i>S. abortus ovis</i> )	
Screw-worm fly – New World – ( <i>Cochliomyia hominivorax</i> )	
Screw –worm fly – Old World – ( <i>Chrysomya bezziana</i> )	
Sheep pox and goat pox	
Sheep scab	
Surra ( <i>Trypanosoma evansi</i> )	
Swine influenza (other than influenza pandemic (H1N1) 2009)	
Swine vesicular disease	
Transmissible gastroenteritis	
Transmissible spongiform encephalopathies (bovine spongiform encephalopathy, chronic wasting disease of deer, feline spongiform encephalopathy, scrapie)	
Trichinellosis	
Tropilaelaps mite ( <i>Tropilaelaps clareae</i> )	
Trypanosomosis (tsetse fly associated)	
Tularaemia	
Turkey rhinotracheitis (avian metapneumovirus)	
Varroasis ( <i>Varroa destructor</i> )	
Varroasis ( <i>Varroa jacobsoni</i> )	
Vesicular exanthema	
Vesicular stomatitis	
Virulent porcine circovirus	
Warble-fly myiasis	
Wesselsbron disease	
West Nile virus infection	

Diseases in stock recognised as endemic or sporadic

Column 1	Column 2
Anaplasmosis	
Anthrax	
Babesiosis	

Column 1	Column 2
Cattle tick ( <i>Boophilus microplus</i> )	
Chalk brood ( <i>Ascophaera apis</i> ) in honeybees	Only section 9
Chlamydiosis in birds other than poultry	Only section 9
Chlamydiosis in poultry	
Cysticercus bovis ( <i>Taenia saginata</i> )	
Egg drop syndrome (EDS 76)	Only section 9
Enzootic bovine leucosis	
Equine herpes – virus 1 (abortigenic strain)	Only section 9
Equine infectious anaemia	Only section 9
Equine viral arteritis	Only section 9
European foulbrood ( <i>Melissococcus pluton</i> ) in honeybees	Only section 9
Footrot in sheep and goats	
Infectious laryngotracheitis	Only section 9
Johne's disease ( <i>Paratuberculosis</i> )	All provisions other than sections 20B, 20C (1) (a) & (c), 20C (2), 20C (3A) (a), 20C (4), 20C (5) and 20C (5A)
Ovine brucellosis caused by <i>Brucella ovis</i>	All provisions other than section 9
Nosemosis in honeybees	Only section 9
Porcine Myocarditis (Bungowannah virus infection)	
Pullorum disease ( <i>Salmonella pullorum</i> )	
<i>Salmonella enteritidis</i> infection in poultry	
Sheep ked	
Sheep lice	All provisions other than sections 9 and 20B
Small Hive Beetle ( <i>Aethina tumida</i> )	Only section 9
Strangles	Only section 9
Trichomoniasis	Only section 9
Tuberculosis (mammalian or avian)	

Signed and sealed at Sydney this 20th day of July 2011.

By Her Excellency's Command

KATRINA HODGKINSON, M.P.,  
Minister for Primary Industries

GOD SAVE THE QUEEN!

**STOCK DISEASES ACT 1923**

Appointment of Inspector

Notification No. 531

I, ANDREW COLIN SANGER, Director Agricultural Compliance of the Department of Trade and Investment, Regional Infrastructure and Services, pursuant to section 6 (1) of the Stock Diseases Act 1923 ("the Act") and with the delegated authority of the Director-General of the Department of Trade and Investment, Regional Infrastructure and Services pursuant to section 22C of the Act hereby appoint Jillian Keogh KELLY as an inspector for the purposes of the Act.

Dated this 18th day of July 2011.

A. C. SANGER,  
Director, Agricultural Compliance,  
Department of Trade and Investment,  
Regional Infrastructure and Services

**STOCK MEDICINES ACT 1989****ORDER**

Authorisation of Inspector

I, ANDREW COLIN SANGER, Director Agricultural Compliance of the Department of Trade and Investment, Regional Infrastructure and Services, pursuant to section 48 of the Stock Medicines Act 1989 ("the Act") and with the delegated authority of the Director-General of the Department of Trade and Investment, Regional Infrastructure and Services pursuant to section 64 of the Act hereby authorise Jillian Keogh KELLY to be an inspector for the purposes of the Act.

Dated this 18th day of July 2011.

A. C. SANGER,  
Director, Agricultural Compliance,  
Department of Trade and Investment,  
Regional Infrastructure and Services

**MINERAL RESOURCES**

NOTICE is given that the following applications have been received:

**EXPLORATION LICENCE APPLICATIONS**

(T11-0199)

No. 4313, PINNACLE GOLD PTY LTD (ACN 151 778 424), area of 100 units, for Group 1, dated 6 July 2011. (Armidale Mining Division).

(T11-0200)

No. 4314, PINNACLE GOLD PTY LTD (ACN 151 778 424), area of 100 units, for Group 1, dated 6 July 2011. (Armidale Mining Division).

(T11-0201)

No. 4315, PINNACLE GOLD PTY LTD (ACN 151 778 424), area of 100 units, for Group 1, dated 6 July 2011. (Armidale Mining Division).

(T11-0203)

No. 4317, NEWMONT EXPLORATION PTY LTD (ACN 006 306 690), area of 86 units, for Group 1, dated 8 July 2011. (Orange Mining Division).

(T11-0204)

No. 4318, CGNM RESOURCES PTY LTD (ACN 139 443 137), area of 37 units, for Group 1, dated 8 July 2011. (Broken Hill Mining Division).

(T11-0205)

No. 4319, ABX2 PTY LTD (ACN 139 791 478), area of 200 units, for Group 6, dated 12 July 2011. (Sydney Mining Division).

(T11-0206)

No. 4320, ABX2 PTY LTD (ACN 139 791 478), area of 101 units, for Group 2 and Group 6, dated 14 July 2011. (Sydney Mining Division).

(T11-0207)

No. 4321, GOODRICH RESOURCES PTY LTD (ACN 150 737 563), area of 22 units, for Group 1, dated 14 July 2011. (Orange Mining Division).

(T11-0208)

No. 4322, GOLD FIELDS AUSTRALASIA PTY LTD (ACN 087 624 600), area of 22 units, for Group 1, dated 14 July 2011. (Orange Mining Division).

(T11-0209)

No. 4323, ABX2 PTY LTD (ACN 139 791 478), area of 102 units, for Group 2 and Group 6, dated 14 July 2011. (Sydney Mining Division).

(T11-0231)

No. 4324, TELLUS RESOURCES LTD (ACN 144 733 595), area of 16 units, for Group 1, dated 15 July 2011. (Armidale Mining Division).

**MINING LEASE APPLICATIONS**

(11-0372)

No. 407, WERRIS CREEK COAL PTY LIMITED, area of about 96.09 hectares, for the purpose of building, mining plant, road, railway, dam, drain, cable, stockpiling or depositing of overburden, ore or tailings, storing of fuel, machinery and equipment, transmission of electricity, drainage of water, conveyance of electricity and conveyance of materials, dated 11 July 2011. (Armidale Mining Division).

(T11-0005)

No. 408, CREEK RESOURCES PTY LTD (ACN 100 228 886) and BETALPHA PTY LTD (ACN 105 663 518), area of about 99.81 hectares, to mine for coal, dated 11 July 2011. (Armidale Mining Division).

(T11-0006)

No. 409, WERRIS CREEK COAL PTY LIMITED, area of about 30.73 hectares, to mine for coal, dated 11 July 2011. (Armidale Mining Division).

CHRIS HARTCHER, M.P.,  
Minister for Resources and Energy

NOTICE is given that the following applications have been granted:

**EXPLORATION LICENCE APPLICATIONS**

(T09-0284)

No. 3878, now Exploration Licence No. 7785, ARGENT MINERALS LIMITED (ACN 124 780 276), Counties of Bathurst and Georgiana, Map Sheet (8730), area of 68 units, for Group 1, dated 16 June 2011, for a term until 16 June 2013.

(T10-0123)

No. 3992, now Exploration Licence No. 7786, NEWMONT EXPLORATION PTY LTD (ACN 006 306 690), County of Lincoln, Map Sheet (8733), area of 9 units, for Group 1, dated 16 June 2011, for a term until 16 June 2013.

(T10-0161)

No. 4031, now Exploration Licence No. 7787, VINCENT RESOURCES PTY LTD (ACN 142 721 579), Counties of Clyde and Cowper, Map Sheet (8236, 8237), area of 366 units, for Group 1, dated 16 June 2011, for a term until 16 June 2013.

(T10-0217)

No. 4081, now Exploration Licence No. 7788, NEWMONT EXPLORATION PTY LTD (ACN 006 306 690), Counties of Bathurst and Wellington, Map Sheet (8731), area of 65 units, for Group 1, dated 16 June 2011, for a term until 16 June 2013.

(T10-0292)

No. 4136, now Exploration Licence No. 7795, PANGAEA MINERALS PTY LIMITED (ACN 120 631 316), Counties of Fitzgerald and Ularara, Map Sheet (7537), area of 144 units, for Group 1, dated 24 June 2011, for a term until 24 June 2013.

(T11-0029)

No. 4151, now Exploration Licence No. 7796, VALBOB MINING PTY LIMITED (ACN 071 196 346), Counties of Arrawatta and Gough, Map Sheet (9238), area of 6 units, for Group 1, dated 4 July 2011, for a term until 4 July 2013.

(T11-0034)

No. 4156, now Exploration Licence No. 7789, MINCOR COPPER PTY LTD (ACN 120 024 777), County of Flinders, Map Sheet (8133, 8134, 8233, 8234), area of 42 units, for Group 1, dated 16 June 2011, for a term until 16 June 2013.

(T11-0035)

No. 4157, now Exploration Licence No. 7790, MINCOR COPPER PTY LTD (ACN 120 024 777), County of Flinders, Map Sheet (8233), area of 22 units, for Group 1, dated 16 June 2011, for a term until 16 June 2013.

(T11-0042)

No. 4163, now Exploration Licence No. 7766, IRGS NORTHERN GOLD PTY LTD (ACN 149 177 999), County of Sandon, Map Sheet (9236, 9237), area of 98 units, for Group 1, dated 6 June 2011, for a term until 6 June 2013.

(T11-0043)

No. 4164, now Exploration Licence No. 7767, IRGS SOUTHERN GOLD PTY LTD (ACN 149 179 920), Counties of King and Murray, Map Sheet (8727, 8728), area of 100 units, for Group 1, dated 6 June 2011, for a term until 6 June 2013.

(T11-0065)

No. 4186, now Exploration Licence No. 7791, MINCOR COPPER PTY LTD (ACN 120 024 777), Counties of Flinders, Kennedy and Oxley, Map Sheet (8333, 8334), area of 98 units, for Group 1, dated 16 June 2011, for a term until 16 June 2013.

(T11-0066)

No. 4187, now Exploration Licence No. 7792, MINCOR COPPER PTY LTD (ACN 120 024 777), Counties of Flinders

and Kennedy, Map Sheet (8333), area of 15 units, for Group 1, dated 16 June 2011, for a term until 16 June 2013.

(T11-0067)

No. 4188, now Exploration Licence No. 7793, MINCOR COPPER PTY LTD (ACN 120 024 777), County of Kennedy, Map Sheet (8333), area of 5 units, for Group 1, dated 16 June 2011, for a term until 16 June 2013.

(T11-0068)

No. 4189, now Exploration Licence No. 7794, MINCOR COPPER PTY LTD (ACN 120 024 777), Counties of Kennedy, Narromine and Oxley, Map Sheet (8333, 8433), area of 14 units, for Group 1, dated 16 June 2011, for a term until 16 June 2013.

(T11-0069)

No. 4190, now Exploration Licence No. 7768, IRGS NORTHERN GOLD PTY LTD (ACN 149 177 999), County of Hardinge, Map Sheet (9137), area of 100 units, for Group 1, dated 6 June 2011, for a term until 6 June 2013.

(T11-0070)

No. 4191, now Exploration Licence No. 7769, IRGS NORTHERN GOLD PTY LTD (ACN 149 177 999), Counties of Darling and Hardinge, Map Sheet (9037, 9137), area of 82 units, for Group 1, dated 6 June 2011, for a term until 6 June 2013.

(T11-0071)

No. 4192, now Exploration Licence No. 7770, IRGS NORTHERN GOLD PTY LTD (ACN 149 177 999), Counties of Inglis, Parry and Vernon, Map Sheet (9135), area of 100 units, for Group 1, dated 6 June 2011, for a term until 6 June 2013.

CHRIS HARTCHER, M.P.,  
Minister for Resources and Energy

NOTICE is given that the following application has been refused:

#### EXPLORATION LICENCE APPLICATION

(T11-0106)

No. 4226, TELLUS RESOURCES LTD (ACN 144 733 595), County of Brisbane and County of Durham, Map Sheet (9133, 9134). Refusal took effect on 4 July 2011.

CHRIS HARTCHER, M.P.,  
Minister for Resources and Energy

NOTICE is given that the following applications have been withdrawn:

#### EXPLORATION LICENCE APPLICATIONS

(T11-0148)

No. 4263, MINCOR IRON HOLDINGS PTY LTD (ACN 149 551 011), County of Culgoa, Map Sheet (8339). Withdrawal took effect on 15 July 2011.

(T11-0193)

No. 4307, PINNACLE GOLD PTY LTD (ACN 151 778 424), County of Landsborough, Map Sheet (7836, 7837). Withdrawal took effect on 6 July 2011.

(T11-0194)

No. 4308, PINNACLE GOLD PTY LTD (ACN 151 778 424), County of Landsborough, Map Sheet (7736, 7737, 7837). Withdrawal took effect on 6 July 2011.

(T11-0195)

No. 4309, PINNACLE GOLD PTY LTD (ACN 151 778 424), County of Killara and County of Landsborough, Map Sheet (7736, 7737). Withdrawal took effect on 6 July 2011.

(T11-0196)

No. 4310, PINNACLE GOLD PTY LTD (ACN 151 778 424), County of Killara, Map Sheet (7736). Withdrawal took effect on 6 July 2011.

(T11-0197)

No. 4311, ABX2 PTY LTD (ACN 139 791 478), County of Argyle, County of Georgiana and County of King, Map Sheet (8728, 8729, 8828, 8829). Withdrawal took effect on 19 July 2011.

CHRIS HARTCHER, M.P.,  
Minister for Resources and Energy

NOTICE is given that the following applications for renewal have been received:

(11-3658)

Authorisation No. 287, KEPSCO BYLONG AUSTRALIA PTY LTD (ACN 075 361 769), area of 6685 hectares. Application for renewal received 5 July 2011.

(08-5091)

Authorisation No. 342, KEPSCO BYLONG AUSTRALIA PTY LTD (ACN 075 361 769), area of 3700 hectares. Application for renewal received 5 July 2011.

(11-3912)

Exploration Licence No. 5879, PERILYA BROKEN HILL LIMITED (ACN 099 761 289), area of 5 units. Application for renewal received 14 July 2011.

(05-0169)

Exploration Licence No. 6447, PERILYA BROKEN HILL LIMITED (ACN 099 761 289), area of 8 units. Application for renewal received 11 July 2011.

(05-0217)

Exploration Licence No. 6462, BIG ISLAND MINING PTY LTD (ACN 112 787 470), area of 100 units. Application for renewal received 5 July 2011.

(07-0099)

Exploration Licence No. 6822, CLANCY EXPLORATION LIMITED (ACN 105 578 756), area of 42 units. Application for renewal received 8 July 2011.

(T06-7048)

Exploration Licence No. 6840, IRONBARK ZINC LIMITED (ACN 118 751 027), area of 7 units. Application for renewal received 15 July 2011.

(T09-0052)

Exploration Licence No. 7361, ABX1 PTY LTD (ACN 139 790 364), area of 100 units. Application for renewal received 15 July 2011.

CHRIS HARTCHER, M.P.,  
Minister for Resources and Energy

## RENEWAL OF CERTAIN AUTHORITIES

NOTICE is given that the following authorities have been renewed:

(07-6427)

Exploration Licence No. 2934, SULTAN CORPORATION LIMITED (ACN 061 219 985), County of Georgiana, Map Sheet (8729), area of 6 units, for a further term until 22 October 2012. Renewal effective on and from 18 July 2011.

(06-7572)

Exploration Licence No. 4474, PMR1 PTY LTD (ACN 145 210 528), Counties of Clarke and Sandon, Map Sheet (9336), area of 4 units, for a further term until 12 January 2013. Renewal effective on and from 14 July 2011.

(T04-0042)

Exploration Licence No. 6358, FORGE RESOURCES LTD (ACN 139 886 187), Counties of Argyle and Murray, Map Sheet (8827), area of 9 units, for a further term until 23 December 2012. Renewal effective on and from 8 July 2011.

(07-0274)

Exploration Licence No. 7124, HILL END GOLD LIMITED (ACN 072 692 365), County of Wakool, Map Sheet (7627), area of 47 units, for a further term until 11 April 2012. Renewal effective on and from 7 June 2011.

(T08-0090)

Exploration Licence No. 7210, ALLIANCE (NSW) PTY LTD (ACN 096 947 223), County of Yancowinna, Map Sheet (7134), area of 4 units, for a further term until 1 October 2012. Renewal effective on and from 4 July 2011.

(T08-0070)

Exploration Licence No. 7256, CARPENTARIA EXPLORATION LIMITED (ACN 095 117 981), County of Bland, Map Sheet (8429), area of 4 units, for a further term until 2 December 2012. Renewal effective on and from 4 July 2011.

(T08-0208)

Exploration Licence No. 7269, ABX2 PTY LTD (ACN 139 791 478), County of Argyle, Map Sheet (8827, 8828), area of 90 units, for a further term until 23 December 2012. Renewal effective on and from 14 July 2011.

CHRIS HARTCHER, M.P.,  
Minister for Resources and Energy

## REFUSAL OF APPLICATIONS FOR RENEWAL

NOTICE is given that the applications for renewal in respect of the following authorities have been refused:

(06-4098)

Exploration Licence No. 6680, ICON RESOURCES LTD (ACN 115 009 106), County of Darling, Map Sheet (9036, 9037), area of 47 units. The authority ceased to have effect on 12 July 2011.

(06-4099)

Exploration Licence No. 6681, ICON RESOURCES LTD (ACN 115 009 106), Counties of Burnett and Murchison, Map Sheet (9038), area of 74 units. The authority ceased to have effect on 12 July 2011.



(06-4100)

Exploration Licence No. 6682, ICON RESOURCES LTD (ACN 115 009 106), Counties of Darling and Inglis, Map Sheet (9036), area of 42 units. The authority ceased to have effect on 12 July 2011.

(06-4121)

Exploration Licence No. 6683, ICON RESOURCES LTD (ACN 115 009 106), Counties of Parry and Vernon, Map Sheet (9135), area of 16 units. The authority ceased to have effect on 12 July 2011.

CHRIS HARTCHER, M.P.,  
Minister for Resources and Energy

---

### **CANCELLATION OF AUTHORITIES AT REQUEST OF HOLDERS**

NOTICE is given that the following authorities have been cancelled:

(T08-0217)

Exploration Licence No. 7362, MIKADA RESOURCES PTY LTD (ACN 132 471 446), County of Argyle and County of Georgiana, Map Sheet (8829), area of 11 units. Cancellation took effect on 6 July 2011.

(T09-0104)

Exploration Licence No. 7402, NEWMONT EXPLORATION PTY LTD (ACN 006 306 690), County of Narromine, Map Sheet (8433, 8533), area of 18 units. Cancellation took effect on 8 July 2011.

CHRIS HARTCHER, M.P.,  
Minister for Resources and Energy

---

### **TRANSFERS**

(10-0880)

Exploration Licence No. 5297, formerly held by RAVENSWORTH OPERATIONS PTY LIMITED (ACN 098 937 761) has been transferred to CUMNOCK NO. 1 COLLIERY PTY LIMITED (ACN 051 932 122) and ICRA CUMNOCK PTY LTD (ACN 129 006 819). The transfer was registered on 7 July 2011.

(11-0244)

Exploration Licence No. 7407, formerly held by COALWORKS (VICKERY SOUTH) PTY LTD (ACN 138 395 141) has been transferred to COALWORKS (VICKERY SOUTH) PTY LTD (ACN 138 395 141) and ICRA VICKERY PTY LTD (ACN 142 525 282). The transfer was registered on 7 July 2011.

(10-0880)

Mining Lease No. 1576 (Act 1992), formerly held by RAVENSWORTH OPERATIONS PTY LIMITED (ACN 098 937 761) has been transferred to CUMNOCK NO. 1 COLLIERY PTY LIMITED (ACN 051 932 122) and ICRA CUMNOCK PTY LTD (ACN 129 006 819). The transfer was registered on 7 July 2011.

CHRIS HARTCHER, M.P.,  
Minister for Resources and Energy

---

### **EXPIRIES**

Mining Claim Converted to Lease No. 314 (Act 1992), Gordon Walton PATERSON, Parish of Parker, County of Caira. This title expired on 11 July 2011.

Mining Claim Converted to Lease No. 315 (Act 1992), Lachlan Ian PATERSON, Parish of Parker, County of Caira. This title expired on 11 July 2011.

CHRIS HARTCHER, M.P.,  
Minister for Resources and Energy

---

**LANDS**

---

**ARMIDALE CROWN LANDS OFFICE**  
**108 Faulkner Street (PO Box 199A), Armidale NSW 2350**  
**Phone: (02) 6770 3100      Fax (02) 6771 5348**

**NOTIFICATION OF CLOSING OF ROAD**

IN pursuance of the provisions of the Roads Act 1993, the road hereunder described is closed and the land comprised therein ceases to be a public road and the rights of passage and access that previously existed in relation to the road are extinguished. On road closing, title to the land comprising the former public road vests in the body specified in the Schedule hereunder.

KATRINA HODGKINSON, M.P.,  
Minister for Primary Industries

---

**Description**

*Land District – Walcha; L.G.A. – Walcha*

Road Closed: Lot 1, DP 1165842 at Walcha, Parish Tia,  
County Vernon.

File No.: AE06 H 62.

**Schedule**

On closing, the land within Lot 1, DP 1165842 remains  
vested in the State of New South Wales as Crown Land.

**GOULBURN OFFICE****159 Auburn Street (PO Box 748), Goulburn NSW 2580****Phone: (02) 4824 3700      Fax: (02) 4822 4287****NOTIFICATION OF CLOSING OF A ROAD**

IN pursuance of the provisions of the Roads Act 1993, the road hereunder described is closed and the lands comprised therein cease to be public road and the rights of passage and access that previously existed in relation to the road is extinguished. Upon closing, title to the land, comprising the former public road, vests in the body specified in the Schedule hereunder.

KATRINA HODGKINSON, M.P.,  
Minister for Primary Industries

\_\_\_\_\_  
Description

*Parish – Pejar; County – Argyle;  
Land District – Crookwell;  
L.G.A. – Upper Lachlan Shire Council*

Lot 1, DP 1160163 (not being land under the Real Property Act and subject to easement for right of carriageway created by Deposited Plan 1160163).

File No.: GB05 H 189:BA.

Schedule

On closing, the title for the land in Lot 1, DP 1160163 remains vested in the State of New South Wales as Crown Land.

\_\_\_\_\_  
Description

*Parish – Winduella; County – King;  
Land District – Crookwell;  
L.G.A. – Upper Lachlan Shire Council*

Lot 1, DP 1155759 (not being land under the Real Property Act).

File No.: GB05 H 139:BA.

Schedule

On closing, the title for the land in Lot 1, DP 1155759 remains vested in the State of New South Wales as Crown Land.

Description

*Parish – Barnet; County – Murray;  
Land District – Braidwood;  
L.G.A. – Palerang Council*

Lot 2, DP 1158319 (not being land under the Real Property Act).

File No.: 09/10742:BA.

Schedule

On closing, the title for the land in Lot 2, DP 1158319 remains vested in the State of New South Wales as Crown Land.

\_\_\_\_\_  
Description

*Parish – Elrington; Village – Majors Creek;  
County – St Vincent; Land District – Braidwood;  
L.G.A. – Palerang Council*

Lot 1, DP 1154717 (not being land under the Real Property Act).

File No.: 07/6153:BA.

Schedule

On closing, the title for the land in Lot 1, DP 1154717 remains vested in the State of New South Wales as Crown Land.



**GRAFTON OFFICE**  
**76 Victoria Street (PO Box 272), Grafton NSW 2460**  
**Phone: (02) 6640 3400      Fax: (02) 6642 5375**

**ERRATUM**

IN the Declarations which appeared in the *New South Wales Government Gazette* No. 90 of 15 July 2005, Folio 3753, under the heading "Declaration of Land to be Crown Land", the declaration should have read "Pursuant to section 138 of the Crown Lands Act 1989, the land described in the Schedule hereunder is declared to be Crown land within meaning of that Act."

File Nos: GF05R44 and GF05 R20.

KATRINA HODGKINSON, M.P.,  
Minister for Primary Industries

**DISSOLUTION OF RESERVE TRUST**

PURSUANT to section 92(3) of the Crown Lands Act 1989, the reserve trust specified in Column 1 of the Schedule hereunder, which was established in respect of the reserve specified opposite thereto in Column 2 of the Schedule, is dissolved.

KATRINA HODGKINSON, M.P.,  
Minister for Primary Industries

**SCHEDULE**

<i>Column 1</i>	<i>Column 2</i>
Camp Marsh Boys Brigade Reserve Trust.	Reserve No.: 91596. Public Purpose: Public recreation and community centre. Notified: 18 January 1980. File No.: GF00 R 22.

**NOTIFICATION OF CLOSING OF ROAD**

IN pursuance of the provisions of the Roads Act 1993, the road hereunder described is closed and the land comprised therein ceases to be a public road and the rights of passage and access that previously existed in relation to the road are extinguished. On road closing, title to the land comprising the former public road vests in the body specified in the Schedule hereunder.

KATRINA HODGKINSON, M.P.,  
Minister for Primary Industries

**Description**

*Land District – Lismore; L.G.A. – Ballina*

Roads Closed: Lot 20, DP 1164159 at Cumbalum, Parish Ballina, County Rous.

DPI File Reference: 09/10162.

**Schedule**

On closing, the land within Lot 20, DP 1164159 remains vested in Ballina Shire Council as operational land for the purposes of the Local Government Act 1993.

Councils Reference: DA 2003/413.

**Description**

*Land District – Lismore; L.G.A. – Ballina*

Road Closed: Lot 3, DP 1157060 at Newrybar, Parish Teven, County Rous.

File No.: 09/10716.

**Schedule**

On closing, the land within Lot 3, DP 1157060 remains vested in the State of New South Wales as Crown Land.

**Description**

*Land District – Lismore; L.G.A. – Byron*

Road Closed: Lot 1, DP 1162217 at Coopers Shoot, Parish Byron, County Rous.

File No.: GF06 H 295.

**Schedule**

On closing, the land within Lot 1, DP 1162217 remains vested in the State of New South Wales as Crown Land.

**Description**

*Land District – Murwillumbah; L.G.A. – Tweed*

Road Closed: Lot 2, DP 1159231 at Duranbah, Parish Cudgen, County Rous.

File No.: 10/06504.

**Schedule**

On closing, the land within Lot 2, DP 1159231 remains vested in the State of New South Wales as Crown Land.

**Description**

*Land District – Grafton; L.G.A. – Clarence Valley*

Road Closed: Lot 1, DP 1166507 at Dilkoon, Parish Clifden, County Clarence.

File No.: 07/3116.

**Schedule**

On closing, the land within Lot 1, DP 1166507 remains vested in the State of New South Wales as Crown Land.

**Description**

*Land District – Murwillumbah; L.G.A. – Tweed*

Road Closed: Lot 1, DP 1165676 at Chinderah, Parish Cudgen, County Rous.

File No.: 07/3192.

**Schedule**

On closing, the land within Lot 1, DP 1165676 remains vested in the State of New South Wales as Crown Land.

**NOTICE OF INTENTION TO GRANT A LEASE  
OVER A CROWN RESERVE**

PURSUANT to section 34A(2)(b) of the Crown Lands Act 1989, it is notified that the Minister administering the Crown Lands Act 1989, intends to create a relevant interest by way of a lease for the purposes specified in Column 1 of the Schedule to the party specified in Column 2 of the Schedule in respect of the Reserve specified in Column 3 of the Schedule.

KRISTINA HODGKINSON, M.P.,  
Minister for Primary Industries

SCHEDULE

<i>Column 1</i>	<i>Column 2</i>	<i>Column 3</i>
Recreation purposes, short term accommodation and caravan and camping park.	Camp Koinonia Holdings Pty Ltd.	Reserve No.: 91596. Land District: Casino. Local Government Area: Lismore. Parish: Bungabbee. County: Rous. Locality: Rock Valley. Public Purpose: Community centre and public recreation. Notified: 18 January 1980. File No.: 10/08397.

**HAY OFFICE**  
**126 Lachlan Street (PO Box 182), Hay NSW 2711**  
**Phone: (02) 6990 1800      Fax: (02) 6993 1135**

**NOTIFICATION OF CLOSING OF PUBLIC ROAD**

IN pursuance of the provisions of the Roads Act 1993, the road hereunder described is closed and the land comprised therein ceases to be a public road and the rights of passage and access that previously existed in relation to the road are extinguished. On road closure, title to the land comprising the former public road vests in the body specified in the Schedule hereunder.

KATRINA HODGKINSON, M.P.,  
Minister for Primary Industries

Description

*Land District of Deniliquin; L.G.A. – Conargo*

Lot 4 in DP 1164889, Parish of Monimail, County of Townsend.

File No.: 09/11415.

Schedule

On closing, title for the land comprised in Lot 4, DP 1164889 remains vested in the State of New South Wales as Crown Land.

Description

*Land District of Deniliquin; L.G.A. of Murray*

Lots 1 and 2 in DP 1151193, Parish of Derrulaman, County of Townsend.

File No.: 08/0550.

Schedule

On closing, title for the land comprised in Lots 1 and 2, DP 1151193 remains vested in the State of New South Wales as Crown Land.

**MAITLAND OFFICE****Corner Newcastle Road and Banks Street (PO Box 6), East Maitland NSW 2323****Phone: (02) 4937 9300 Fax: (02) 4934 2252****APPOINTMENT OF ADMINISTRATOR TO  
MANAGE A RESERVE TRUST**

PURSUANT to section 117, Crown Lands Act 1989, the person specified in Column 1 of the Schedule hereunder, is appointed as administrator for the term also specified, of the reserve trust specified opposite thereto in Column 2, which is trustee of the reserve referred to in Column 3 of the Schedule.

KATRINA HODGKINSON, M.P.,  
Minister for Primary Industries

**SCHEDULE**

<i>Column 1</i>	<i>Column 2</i>	<i>Column 3</i>
Jamin RYAN.	Lake Glenbawn State Park Trust.	Dedication No.: 1001337. Public Purpose: Public recreation. Notified: 1 June 1997. File No.: MD92 R 10.

For a term commencing the date of this notice and expiring  
21 October 2011.

**NEWCASTLE OFFICE****437 Hunter Street, Newcastle NSW 2300 (PO Box 2185, Dangar NSW 2309****Phone: (02) 4925 4104 Fax: (02) 4925 3517****NOTIFICATION OF CLOSING OF PUBLIC ROAD**

IN pursuance of the provisions of the Roads Act 1993, the road hereunder described is closed and the land comprised therein ceases to be a public road and the rights of passage and access that previously existed in relation to the road are extinguished. On road closing, title to the land comprising the former public road vests in the body specified in the Schedule hereunder.

KATRINA HODGKINSON, M.P.,  
Minister for Primary Industries

\_\_\_\_\_  
Description

*Parish – Toogong; County – Ashburnham;  
Land District – Molong; L.G.A. – Cabonne*

Road Closed: Lot 1, DP 1166329 (not being land under the Real Property Act).

File No.: OE05 H 134.

Schedule

On closing, the land within Lot 1, DP 1166329 remains vested in the State of New South Wales as Crown Land.

\_\_\_\_\_

**NOWRA OFFICE**  
**5 O’Keefe Avenue (PO Box 309), Nowra NSW 2541**  
**Phone: (02) 4428 9100      Fax: (02) 4421 2172**

**APPOINTMENT OF RESERVE TRUST AS TRUSTEE  
OF A RESERVE**

PURSUANT to section 92(1) of the Crown Lands Act 1989, the reserve trust specified in Column 1 of the Schedule hereunder, is appointed as trustee of the reserve specified opposite thereto in Column 2 of the Schedule.

KATRINA HODGKINSON, M.P.,  
Minister for Primary Industries

**SCHEDULE**

<i>Column 1</i>	<i>Column 2</i>
Eurobodalla (North) Reserve Trust.	Reserve No.: 33117. Public Purpose: Public buildings. Notified: 17 August 1901. File No.: NA81 R 144.

**NOTIFICATION OF CLOSING OF ROAD**

IN pursuance of the provisions of the Roads Act 1993, the road hereunder described is closed and the land comprised therein ceases to be public road and the rights of passage and access that previously existed in relation to the road are extinguished. On road closing, title to the land comprising the former public road vests in the body specified in the Schedule hereunder.

KATRINA HODGKINSON, M.P.,  
Minister for Primary Industries

**Description**

*Parish – Currawang; County – Argyle;  
Land District – Goulburn;  
Local Government Area – Goulburn Mulwaree*

Road Closed: Lot 1, DP 1166971 at Currawang.

File No.: GB07 H 287.

**Schedule**

On closing, the land within Lot 1, DP 1166971 remains vested in the State of New South Wales as Crown Land.

**Description**

*Parish – Thurrallilly; County – Murray;  
Land District – Queanbeyan;  
Local Government Area – Palerang*

Road Closed: Lot 1, DP 1166777 at Rossi subject to an easement for access created by DP 1166777.

File No.: 10/16919.

**Schedule**

On closing, the land within Lot 1, DP 1166777 remains vested in the State of New South Wales as Crown Land.

**Description**

*Parish – Narooma; County – Dampier;  
Land District – Bega;  
Local Government Area – Eurobodalla*

Road Closed: Lot 2, DP 1160136 at Central Tilba.

File No.: 10/03711.

**Schedule**

On closing, the land within Lot 2, DP 1160136 remains vested in the State of New South Wales as Crown Land.

**Description**

*Parishes – Yanununbeyan and Molonglo;  
County – Murray; Land District – Queanbeyan;  
Local Government Area – Palerang*

Road Closed: Lots 1 to 4, DP 1161852 at Hoskinstown and Primrose Valley.

File No.: GB05 H 285.

**Schedule**

On closing, the land within Lots 1 to 4, DP 1161852 remains vested in the State of New South Wales as Crown Land.

**Description**

*Parishes – Ballallaba, Thurrallilly and Yanununbeyan;  
County – Murray; Land District – Queanbeyan;  
Local Government Area – Palerang*

Road Closed: Lots 5 to 10, DP 1165910 at Rossi, Captains Flat and Primrose Valley subject to an easement for access created by DP 1165910.

File No.: GB05 H 285.

**Schedule**

On closing, the land within Lots 5 to 10, DP 1165910 remains vested in the State of New South Wales as Crown Land.

**ORANGE OFFICE**  
**92 Kite Street (PO Box 2146), Orange NSW 2800**  
**Phone: (02) 6391 4300      Fax: (02) 6362 3896**

**NOTIFICATION OF CLOSING OF PUBLIC ROAD**

IN pursuance of the provisions of the Roads Act 1993, the road hereunder described is closed and the land comprised therein ceases to be a public road and the rights of passage and access that previously existed in relation to the road are extinguished. On road closing, title to the land comprising the former public road vests in the body specified in the Schedule hereunder.

KATRINA HODGKINSON, M.P.,  
Minister for Primary Industries

Description

*Parish – Retreat; County – Georgiana;  
Land District – Lithgow*

Road Closed: Lots 1, 5 and 6 in Deposited Plan 1144834.  
File No.: 10/08464.

Schedule

On closing, the land within Lots 1, 5 and 6 in DP 1144834 remains vested in Oberon Council as operational land for the purposes of the Local Government Act 1993.

Description

*Parish – Waldegrave; County – Bathurst;  
Land District – Orange; L.G.A. – Cabonne*

Road Closed: Lot 1 in Deposited Plan 1152172.  
File No.: CL/00793.

Schedule

On closing, title to the land comprised in Lot 1 remains vest in the Crown as Crown Land.

**ROADS ACT 1993**

**ORDER**

Transfer of Crown Road to Council

IN pursuance of the provisions of section 151, Roads Act 1993, the Crown public roads specified in Schedule 1 are transferred to the Roads Authority specified in Schedule 2 hereunder, as from the date of publication of this notice and as from that date, the roads specified in Schedule 1 cease to be Crown public roads.

KATRINA HODGKINSON, M.P.,  
Minister for Primary Industries

SCHEDULE 1

*Parish – Parkes; County – Ashburnham;  
Land District – Parkes*

Docos Road – south Lots 208 and 210, DP 750179; Nash Street – entire length from, and including, east Lot 212, DP 750179 southerly to and including the road east Lot 1, DP 850718; Andrew Stewart Road – east Lot 119, DP 750179 to east Lot 123, DP 750179; Emerton Road – entire length from intersection with Nash Street east to Lot 1, DP 568339 then north to east Lot 127, DP 750179; Unnamed road south Lot 218, DP 750179; Field Road – north Lot 184, DP 750179, Lot 1, DP 712670 and Lot 10, DP 853215; Birch Road – south Lots 2-3, DP 712670 and Lot 11, DP 853215; Price Lane – west Lot 30-31, DP 1113268; Kinsela Lane – intersection north Lot 22, DP 113030 heading northerly to and including the road east Lot 13, DP 150179.

SCHEDULE 2

Roads Authority: Parkes Shire Council.

LPMA File: 10/18937.

Council Reference: SLR:LT (10-653).

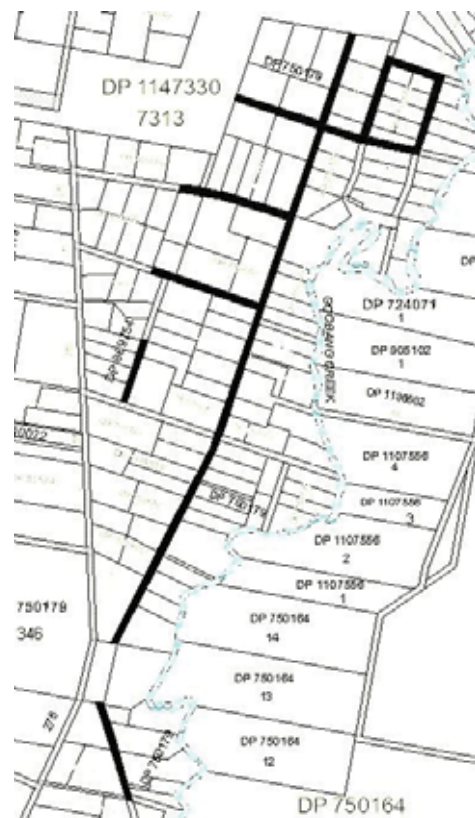



**SYDNEY METROPOLITAN OFFICE**  
**Level 12, Macquarie Tower, 10 Valentine Avenue, Parramatta 2150**  
**(PO Box 3935, Parramatta NSW 2124)**  
**Phone: (02) 8836 5300      Fax: (02) 8836 5365**

**NOTIFICATION OF CLOSING OF ROAD**

IN pursuance of the provisions of the Roads Act 1993, the road hereunder described is closed and the land comprised therein ceases to be public road and the rights of passage and access that previously existed in relation to the road are extinguished. Upon closing, title to the land comprising the former public road vests in the body specified in the Schedule hereunder.

KATRINA HODGKINSON, M.P.,  
Minister for Primary Industries

\_\_\_\_\_  
Description

*Parish – Broken Bay; County – Cumberland;*  
*Land District – Metropolitan;*  
*Local Government Area – Warringah*

Road Closed: Lot 1, DP 1164290 at Duffys Forest.

File No.: MN02 H 213.

Schedule

On closing, the title for the land in Lot 1, DP 1164290 remains vested in the State of New South Wales as Crown Land.

**WESTERN REGION OFFICE**  
**45 Wingewarra Street (PO Box 1840), Dubbo NSW 2830**  
**Phone: (02) 6883 5400      Fax: (02) 6884 2067**

**ESTABLISHMENT OF RESERVE TRUST**

PURSUANT to section 92(1) of the Crown Lands Act 1989, the reserve trust specified in Column 1 of the Schedule hereunder, is established under the name stated in that Column and is appointed as trustee of the reserve specified opposite thereto in Column 2 of the Schedule.

KATRINA HODGKINSON, M.P.,  
Minister for Primary Industries

SCHEDULE

<i>Column 1</i>	<i>Column 2</i>
Birrie River Historical Cemetery Reserve Trust.	Reserve No.: 84982. Public Purpose: Preservation of graves. Notified: 21 August 1964. File No.: 11/08529.

**APPOINTMENT OF CORPORATION TO MANAGE RESERVE TRUST**

PURSUANT to section 95 of the Crown Lands Act 1989, the corporation specified in Column 1 of the Schedule hereunder, is appointed to manage the affairs of the reserve trust specified opposite thereto in Column 2, which is trustee of the reserve referred to in Column 3 of the Schedule.

KATRINA HODGKINSON, M.P.,  
Minister for Primary Industries

SCHEDULE

<i>Column 1</i>	<i>Column 2</i>	<i>Column 3</i>
Brewarrina Shire Council.	Birrie River Historical Cemetery Reserve Trust.	Reserve No.: 84982. Public Purpose: Preservation of graves. Notified: 21 August 1964. File No.: 11/08529.

For a term commencing the date of this notice.

**WATER****WATER ACT 1912**

AN application for a licence, under the section 10 of Part 2 of the Water Act 1912, as amended, has been received as follows:

PETER MERVYN WARD for a pump on the Colo River on Lot 23, DP 751632, Parish of Colo, County of Cook, for the irrigation of 20.0 hectares (orchard, vegetables) (replacement licence – replacing 10SL055411 and permanent transfer of 18.0 megalitres from 10SL055530) (no increase in annual water entitlement) (not subject to the 2003 amended Hawkesbury/Nepean Embargo). (Ref:10SL057108)

DANIEL and JEVON SAMMUT for a pump on the Hawkesbury River on Lot 101, DP 1154658, Parish of Pitt Town, County of Cumberland, for the irrigation of 2.5 hectares (turf) (part replacement licence – part replaces 10SL056774) (no increase in annual water entitlement) (not subject to the 2003 amended Hawkesbury/Nepean Embargo). (Ref:10SL057104)

DANIEL and JEVON SAMMUT for a pump on the Hawkesbury River on Lot 102, DP 1154658, Parish of Pitt Town, County of Cumberland, for the irrigation of 12.5 hectares (turf) (replacement licence – part replaces 10SL056774 and replaces 10SL056758) (no increase in annual water entitlement) (not subject to the 2003 amended Hawkesbury/Nepean Embargo). (Ref:10SL057103)

GEOFFREY COLIN, KATHERINE JOYCE and GARNET LEONARD RIDGE for a pump on the Hawkesbury River on Part Lot 2, DP 77950, Parish of Wilberforce, County of Cook, for the irrigation of 9.50 hectares (turf) (part replacement licence – part replaces 10SA002555) (no increase in annual water entitlement) (not subject to the 2003 amended Hawkesbury/Nepean Embargo). (Ref:10SL057040)

LEONARD MAXWELL RIDGE for a pump on the Hawkesbury River on Lot 2, DP 77950, Parish of Wilberforce, County of Cook, for the irrigation of 9.50 hectares (turf) (part replacement licence – part replaces 10SA002555) (no increase in annual water entitlement) (not subject to the 2003 amended Hawkesbury/Nepean Embargo). (Ref:10SL057039)

Any inquiries should be directed to (02) 8838 7531. Written objections, from any local occupier or statutory authority, specifying grounds and how their interests are affected, must be lodged with the NSW Office of Water, PO Box 3720, Parramatta NSW 2124, within 28 days of the date of this publication. GA1819558

WAYNE CONNERS,  
Senior Licensing Officer

**WATER ACT 1912.**

AN application for a licence under Part 2, Section 10 of the Water Act 1912 within a Proclaimed (declared) Local Area under section 5 (4) has been received as follows:

TENTERDEN STATION PTY LTD for a pump and a dam on an unnamed watercourse on Lots 132 and 133, DP 753674, Parish of Skinner, County of Hardinge, for irrigation of 400 hectares (new licence – permanent transfer of an existing entitlement – 200 megalitres) (Local Office reference 90SL101067).

TENTERDEN STATION PTY LTD for a pump and a dam on an unnamed watercourse on Lots 42 and 60, DP 753660, Parish of Everett, County of Hardinge, for irrigation of 170 hectares (new licence – permanent transfer of an existing entitlement – 100 megalitres) (Local Office reference 90SL101068). Any inquiries should be directed to (02) 6701 9600. Written objections to the application specifying grounds thereof may be made by any statutory authority or local occupier within the proclaimed area, whose interests may be affected, must be lodged with the NSW Office of Water, PO Box 550, Tamworth NSW 2400 within 28 days of the date of publication. GA1822140

DAVID THOMAS,  
Senior Licensing Officer

## Roads and Traffic Authority

### ERRATUM

THE notice which appeared in *New South Wales Government Gazette* No. 67 on Folios 4738 to 4746, was published incorrectly, the correct notice starts on Folio 4747.

### ROAD TRANSPORT (GENERAL) ACT 2005

Notice under Clause 20 of the Road Transport (Mass, Loading and Access) Regulation 2005

LISMORE CITY COUNCIL, in pursuance of Division 4 of Part 2 of the Road Transport (Mass, Loading, Access) Regulation 2005, by this Notice, specify the routes and areas on or in which 25 metre B-Doubles may be used subject to any requirements or conditions set out in the Schedule.

Dated: 12 July 2011.

RINO SANTIN,  
Acting General Manager,  
Lismore City Council  
(by delegation from the Minister for Roads)

### SCHEDULE

#### 1. Citation

This Notice may be cited as Lismore City Council 25 metre B-Double Route Notice No. 01/2011.

#### 2. Commencement

This Notice takes effect on the date of gazettal.

#### 3. Effect

This Notice remains in force until 1 September 2015 unless it is amended or repealed earlier.

#### 4. Application

This Notice applies to those 25 metre B-Double vehicles which comply with Schedule 1 of the Road Transport (Mass, Loading and Access) Regulation 2005 and Schedule 2 of the Road Transport (Vehicle Registration) Regulation 2007.

#### 5. Routes

Type	Road Name	Starting Point	Finishing Point
25.	Foley Road, Lismore.	Bruxner Highway.	Taylor Street.
25.	Taylor Street, Lismore.	Foleys Road.	Wardell Street.
25.	Wardell Street, Lismore.	Taylor Street.	Hollingworth Street.
25.	Hollingworth Street, Lismore.	Wardell Street.	Southern end of Hollingworth Street.

**ROAD TRANSPORT (GENERAL) ACT 2005**

Notice under Clause 20 of the Road Transport (Mass, Loading and Access) Regulation 2005

SHELLHARBOUR CITY COUNCIL, in pursuance of Division 4 of Part 2 of the Road Transport (Mass, Loading, Access) Regulation 2005, by this Notice, specify the routes and areas on or in which 25 metre B-Doubles may be used subject to any requirements or conditions set out in the Schedule.

Dated: 16 July 2011.

ARTHUR WEBSTER,  
for General Manager,  
Shellharbour City Council  
(by delegation from the Minister for Roads)

---

**SCHEDULE****1. Citation**

This Notice may be cited as Shellharbour City Council 25 Metre B-Double Route Notice No. 1/2011.

**2. Commencement**

This Notice takes effect on the date of gazettal.

**3. Effect**

This Notice remains in force until 1 September 2015 unless it is amended or repealed earlier.

**4. Application**

This Notice applies to those 25 metre B-Double vehicles which comply with Schedule 1 of the Road Transport (Mass, Loading and Access) Regulation 2005 and Schedule 2 of the Road Transport (Vehicle Registration) Regulation 2007.

**5. Routes**

<i>Type</i>	<i>Road Name</i>	<i>Starting Point</i>	<i>Finishing Point</i>
25m.	Dunmore Road, Dunmore.	MR522 Shellharbour Road.	Southern Cross Drive.
25m.	Southern Cross Drive, Shell Cove.	Dunmore Road.	Bass Point Quarry Road.

**ROAD TRANSPORT (GENERAL) ACT 2005**

Notice under Clause 20 the Road Transport (Mass, Loading and Access) Regulation 2005

TAMWORTH REGIONAL COUNCIL, in pursuance of Division 4 of Part 2 of the Road Transport (Mass, Loading, Access) Regulation 2005, by this Notice, specify the routes and areas on or in which 25 metre B-Doubles may be used subject to any requirements or conditions set out in the Schedule.

Date: 18 July 2011.

PAUL BENNETT,  
General Manager,  
Tamworth Regional Council  
(by delegation from the Minister for Roads)

---

**SCHEDULE****1. Citation**

This Notice may be cited as Tamworth Regional Council 25 Metre B-Double Route Notice No. 1/2011.

**2. Commencement**

This Notice takes effect on date of gazettal.

**3. Effect**

This Notice remains in force until 1 September 2015 unless it is amended or repealed earlier.

**4. Application**

This Notice applies to those 25 metre B-Double vehicles which comply with Schedule 1 of the Road Transport (Mass, Loading and Access) Regulation 2005 and Schedule 2 of the Road Transport (Vehicle Registration) Regulation 2007.

**5. Routes**

<i>Type</i>	<i>Road No.</i>	<i>Road Name</i>	<i>Starting Point</i>	<i>Finishing Point</i>
25		Barry Road (Happy Valley Road), Nundle	Old Hanging Rock Road	Dale & Myers Timber Mill (1.5km from Old Hanging Rock Road)
25		Old Hanging Rock Road, Nundle	Happy Valley Road	Oakenville Street
25		Oakenville Street, Nundle	Old Hanging Rock Road	Nundle Road (bridge over Peel River)
25	MR105	Nundle Road, Nundle	Oakenville Street (bridge over Peel River)	Lindsay's Gap Road
25	MR106	Lindsay's Gap Road, Nundle	Nundle Road	Tamworth Regional/Liverpool Plains Council bdry



**ROAD TRANSPORT (GENERAL) ACT 2005**

Notice under the Road Transport (Mass, Loading and Access) Regulation 2005

TUMBARUMBA SHIRE COUNCIL, in pursuance of the Road Transport (Mass, Loading, Access) Regulation 2005, makes the amendment in the Schedule to the routes and areas previously specified on or in which B-Doubles may be used.

Dated: 15 July 2011.

ALAN LAWRENCE,  
Acting General Manager,  
Tumbarumba Shire Council  
(by delegation from the Minister for Roads)

---

**SCHEDULE****1. Citation**

This Notice may be cited as the Tumbarumba Shire Council B-Doubles Repeal Notice No. 1/2011.

**2. Commencement**

This Notice takes effect on the date of gazettal.

**3. Amendment**

The General B-Double Permit Notice 2010 is amended by omitting the following from that Notice:

<i>Type</i>	<i>Road</i>	<i>Starting Point</i>	<i>Finishing Point</i>
25m.	Maginnity's Gap Road, Tumbarumba.	Upper Boggy Creek Road.	Approx 200m east of Upper Boggy Creek Road.
25m.	Upper Boggy Creek Road, Tumbarumba.	Maginnity's Gap Road.	Mundaroo Road.
25m.	Mundaroo Road, Tumbarumba.	Upper Boggy Creek Road.	Mundaroo Access Road.

**ROAD TRANSPORT (GENERAL) ACT 2005**

Notice under Clause 20 of the Road Transport (Mass, Loading and Access) Regulation 2005

WARRUMBUNGLE SHIRE COUNCIL, in pursuance of Division 4 of Part 2 of the Road Transport (Mass, Loading and Access) Regulation 2005, by this Notice, specify the routes and areas on or in which 25 metre B-Doubles may be used subject to any requirements or conditions set out in the Schedule.

Dated: 18 July 2011.

STEVE LOANE,  
General Manager,  
Warrumbungle Shire Council  
(by delegation from the Minister for Roads)

---

**SCHEDULE****1. Citation**

This Notice may be cited as the Warrumbungle Shire Council 25 metre B- Double Route Notice No. 2/2011.

**2. Commencement**

This Notice takes effect on the date of Gazettal.

**3. Effect**

This Notice remains in force until 31 July 2012 unless it is amended or repealed earlier.

**4. Application**

This Notice applies to Road Trains which comply with Schedule 1 of the Road Transport (Mass, Loading and Access) Regulation 2010 and Schedule 2 of the Road Transport (Vehicle Registration) Regulation 2007.

**5. Routes**

<i>Type</i>	<i>Road No.</i>	<i>Road Name</i>	<i>Starting point</i>	<i>Finishing point</i>	<i>Conditions</i>
25	MR396	Warrumbungles Way, Warrumbungle Shire Council	Newell Highway (HW17)	Bunganbah Abattoir	Access prohibited on school days between the hours of 7.00am and 9.00am, and 3.00pm and 5.00pm.

**ROAD TRANSPORT (GENERAL) ACT 2005**

Notice under Clause 20 of the Road Transport (Mass, Loading and Access) Regulation 2005

WARRUMBUNGLE SHIRE COUNCIL, in pursuance of Division 4 of Part 2 of the Road Transport (Mass, Loading and Access) Regulation 2005, by this Notice, specify the routes and areas on or in which 25 metre B-Doubles may be used subject to any requirements or conditions set out in the Schedule.

Dated: 18 July 2011.

STEVE LOANE,  
General Manager,  
Warrumbungle Shire Council  
(by delegation from the Minister for Roads)

---

**SCHEDULE****1. Citation**

This Notice may be cited as the Warrumbungle Shire Council B Double Route Notice No. 3/2011.

**2. Commencement**

This Notice takes effect annually on 25 April between 9.30am and 1.30pm only.

**3. Effect**

This Notice remains in place each year on 25 April between 9.30am and 1.30pm only.

**4. Application**

This Notice applies to those 25 metre B-Doubles which comply with Schedule 1 of the Road Transport (Mass, Loading and Access) Regulation 2010 and Schedule 2 of the Road Transport (Vehicle Registration) Regulation 2007.

**5. Routes**

B-Double routes within the Warrumbungle Shire Council

<i>Type</i>	<i>Road No.</i>	<i>Road Name</i>	<i>Starting point</i>	<i>Finishing point</i>	<i>Conditions</i>
25	000	Edwards Street, Coonabarabran	John Street (Newell Highway)	Namoi Street	Annually on 25 April between 9.30am and 1.30pm
25	000	Namoi Street, Coonabarabran	Edwards Street	Baradine Road (MR129)	Annually on 25 April between 9.30am and 1.30pm

**ROAD TRANSPORT (GENERAL) ACT 2005**

Notice under Clause 20 of the Road Transport (Mass, Loading and Access) Regulation 2005

YOUNG SHIRE COUNCIL, in pursuance of Division 4 of Part 2 of the Road Transport (Mass, Loading, Access) Regulation 2005, by this Notice, specify the routes and areas on or in which 25 metre B-Doubles may be used subject to any requirements or conditions set out in the Schedule.

Dated: 18 July 2011.

PETER VLATKO,  
General Manager,  
Young Shire Council  
(by delegation from the Minister for Roads)

---

**SCHEDULE****1. Citation**

This Notice may be cited as Young Shire Council 25 Metre B-Double Route Notice No. 1/2011.

**2. Commencement**

This Notice takes effect on the date of gazettal.

**3. Effect**

This Notice remains in force until 18 July 2016 unless it is amended or repealed earlier.

**4. Application**

This Notice applies to those 25 metre B-Double vehicles which comply with Schedule 1 of the Road Transport (Mass, Loading and Access) Regulation 2005 and Schedule 2 of the Road Transport (Vehicle Registration) Regulation 2007.

**5. Routes**

<i>Type</i>	<i>Road Name</i>	<i>Starting Point</i>	<i>Finishing Point</i>
25m.	Colemans Lane, Milvale.	Mr241 Milvale Road.	Shoards Crossing Road.
25m.	Shoards Crossing Road.	Colemans Lane.	Tubbul Road.
25m.	Tubbul Road.	Colemans Lane.	Moonbucca Road.
25m.	Wirrup Road.	Moonbucca Road.	Bribbaree Road.
25m.	Bribbaree Road, Bribbaree.	Quandialla Road.	Young Shire Boundary (west) approaching Mary Gilmore Way.

**ROADS ACT 1993****LAND ACQUISITION (JUST TERMS  
COMPENSATION) ACT 1991**

Notice of Compulsory Acquisition of Land at  
Bullaburra in the Blue Mountains City Council area

THE Roads and Traffic Authority of New South Wales  
by its delegate declares, with the approval of Her  
Excellency the Governor, that the interest in land  
described in schedule below is acquired by compulsory  
process under the provisions of the Land Acquisition  
(Just Terms Compensation) Act 1991 for the purposes  
of the Roads Act 1993.

T D Craig  
Manager, Compulsory Acquisition & Road Dedication  
Roads and Traffic Authority of New South Wales

---

**SCHEDULE****Interest in Land**

An easement in gross to drain water over the land  
situated in the Blue Mountains City Council area, Parish  
of Jamison and County of Cook, described below:

The site designated by the letter [A] on Deposited Plan  
1161636 and described thereon as 'proposed easement  
to drain water 3 wide', being part of the land in  
Certificates of Title 92/7290, 2/945558 and 1/945558.

The land is said to be in the possession The Council of  
the City of Blue Mountains.

(RTA Papers: 11M2000)

## Other Notices

### ANTI-DISCRIMINATION ACT 1977 (NSW)

#### Erratum

THE notice that appeared under the above heading in *New South Wales Government Gazette* No. 72, Folio 5008, dated 15 July 2011, was published incorrectly. The following notice replaces that in full and the gazettal date remains the same.

### ANTI-DISCRIMINATION ACT 1977 (NSW)

#### Exemption Order

- A. Under the provisions of section 126 of the Anti-Discrimination Act 1977 (NSW), an exemption is given to Motor Solutions Australia Pty Ltd from sections 25, 52 and 53 of the Anti-Discrimination Act 1977, to recruit women only for positions of sales consultants in the twenty four franchised Holden Dealers in Metro Sydney (listed in Appendix 1) represented by the Sydney Holden Dealer Council of New South Wales.
- B. Under the provisions of section 126 of the Anti-Discrimination Act 1977, an exemption is given to Sydney Holden Dealer Council of New South Wales from sections 25, 51, and 52 of the Anti-Discrimination Act 1977, to advertise for women only for positions of sales consultants in the twenty four franchised Holden Dealers in Metro Sydney (listed in Appendix 1).
- C. Under the provisions of section 126 of the Anti-Discrimination Act 1977, an exemption is given to the twenty four franchised Holden Dealers in Metro Sydney (listed in Appendix 1) from sections 25, 52 and 53 of the Anti-Discrimination Act 1977, to designate and employ women only for positions of sales consultants in the twenty four franchised Holder Dealers in Metro Sydney (listed in Appendix 1).
- D. Sydney Holden Dealer Council of New South Wales in conjunction with Motor Solutions Australia Pty Ltd are required to provide the Anti-Discrimination Board of New South Wales with a copy of the advertisements relevant to this section 126 of the Anti-Discrimination Act 1977 exemption prior to publication.
- E. Motor Solutions Australia Pty Ltd, the Sydney Dealer Council of New South Wales in conjunction with the twenty four franchised Holden Dealers in Metro Sydney (listed in Appendix 1 of this order) are required to advise the Anti-Discrimination Board of New South Wales, every six months from the date of this Exemption Order, over the period specified in the Order, of the number of females recruited and employed in the designated positions within each reporting period.

This exemption will remain in force for a period of two years from the date given.

Dated this 7th day of July 2011.

STEPAN KERKYASHARIAN, A.O.,  
President,  
Anti-Discrimination Board of NSW

#### APPENDIX 1

24 SHDC Holden Dealers (with ACN/ABN Numbers)

1. Suttons Motors Homebush (ACN 009 670 080).
2. Suttons City Holden Rosebery (ACN 000 057 410).

3. Suttons Motors Arncliffe (ACN 000 083 929).
4. Suttons Motors Chullora (ACN 000 077 056).
5. Suttons Motors Waitara (ACN 000 509 295).
6. Hawkesbury Valley Holden Windsor (ACN 000 552 474).
7. Gateway Holden Wollongong (ACN 095 722 964).
8. Barry Smith Holden Pennant Hills (ABN 24 002 631 914).
9. Paul Wakeling Holden Campbelltown (ACN 119 908 780).
10. Paul Wakeling Holden Camden (ACN 119 908 780).
11. Heartland Holden Blacktown (ACN 096 561 385).
12. Heartland Holden Castle Hill (ACN 096 561 385).
13. Heartland Holden Parramatta (ACN 096 561 385).
14. Heartland Holden Penrith (ACN 096 561 385).
15. Muirs Holden Ashfield (ACN 138 645 155).
16. Peninsula Holden Bankstown (ACN 003 857 832).
17. Col Crawford Holden Brookvale (ACN 001 798 081).
18. Central Coast Holden Gosford (ACN 104 112 576).
19. Central Coast Holden Tuggerah (ACN 104 112 576).
20. McGrath Holden Sutherland (ACN 121 606 808).
21. Lansvale Holden (ACN 121 604 055).
22. McGrath Holden Liverpool (ACN 121 604 055).
23. Hunter Holden Ryde (ACN 003 247 514).
24. Hunter Holden St Leonards (ACN 050 040 107).

### ASSOCIATIONS INCORPORATION ACT 2009

#### Cancellation of Registration Pursuant to Section 80

TAKE notice that CENTRAL TABLELANDS HOUSING ASSOCIATION INCORPORATED (Y2549947) became registered under the Corporations Act 2001 as HOUSING PLUS – ACN 147 459 461, a company limited by guarantee on 19 November 2010 and accordingly its registration under the Associations Incorporation Act 2009 is cancelled as of that date.

Dated 14th day of July 2011.

ANNETTE ROBINSON,  
NSW Fair Trading

### ASSOCIATIONS INCORPORATION ACT 2009

#### Cancellation of Incorporation Pursuant to Section 76

TAKE notice that the incorporation of the following associations is cancelled by this notice pursuant to section 76 of the Associations Incorporation Act 2009.

Cancellation is effective as at the date of gazettal.

Dawit Haile Association Incorporated – Inc9879928.

Dated 14th day of July 2011.

ROBYNE LUNNEY,  
A/Manager,  
Financial Analysis Branch,  
Registry of Co-operatives & Associations,  
Office of Fair Trading,  
Department of Finance & Services

**ASSOCIATIONS INCORPORATION ACT 2009**Reinstatement of Cancelled Association Pursuant to  
Section 84

TAKE notice that the incorporation of DORA CREEK WORKERS CRICKET CLUB INCORPORATED (Y2911718) cancelled on 18 March 2011 is reinstated pursuant to section 84 of the Associations Incorporation Act 2009.

Dated this 20th day of July 2011.

ROBYNE LUNNEY,  
A/Manager, Case Management,  
Registry of Co-operatives & Associations,  
NSW Fair Trading,  
Department of Finance & Services

**GEOGRAPHICAL NAMES ACT 1966**

## Erratum

IN the notice referring to the amendment of address locality boundaries in the Forbes Local Government Area, Folio 5009, 15 July 2011, the notice should have also advised that a new address locality was created named Paytens Bridge. This notice corrects that error.

The position and extent of this feature is shown in the Geographical Names Register of New South Wales which can be viewed on the Geographical Names Board's internet site at [www.gnb@nsw.gov.au](http://www.gnb@nsw.gov.au).

KEVIN RICHARDS,  
Acting Secretary

Geographical Names Board,  
PO Box 143, Bathurst NSW 2795.

**GEOGRAPHICAL NAMES ACT 1966**Notice of Amendment of Address Locality Boundaries  
Within the Sutherland Shire Local Government Area

PURSUANT to the provisions of section 10 of the Geographical Names Act 1966, the Geographical Names Board hereby notifies that it has this day amended the address locality boundaries of Kurnell and Cronulla to enable the creation of a new address locality called Greenhills Beach within the Sutherland Shire Local Government Area as shown on map GNB3721-6.

The position and extent of these features are shown in the Geographical Names Register of New South Wales which can be viewed on the Geographical Names Board's internet site at [www.gnb@nsw.gov.au](http://www.gnb@nsw.gov.au)

KEVIN RICHARDS,  
Acting Secretary

Geographical Names Board  
PO Box 143  
Bathurst NSW 2795

**HEALTH ADMINISTRATION ACT 1982**

## Land Acquisition (Just Terms Compensation) Act 1991

## Notice of Compulsory Acquisition of Land for Hospital

THE Minister for Health declares, with the approval of Her Excellency the Governor, that the land described in the Schedule below is acquired by compulsory process

under the provisions of the Land Acquisition (Just Terms Compensation) Act 1991 for the purpose of the Health Administration Act 1982.

Dated at Sydney, this 13th day of July 2011.

KAREN CRAWSHAW,  
Deputy Director-General,  
Health System Support

**SCHEDULE**

All that piece or parcel of land situated at Wagga Wagga in the Local Government Area of Wagga Wagga, Parish of South Wagga Wagga, County of Wynyard, being Lot 4 of Section B of Deposited Plan 13345.

Office of the Minister for Police  
Sydney, NSW  
19 July 2011

**MISSING PERSON**ONE HUNDRED THOUSAND DOLLARS  
(\$100,000) REWARD

ON the 25 July 2010, Mohammed Ayman ABOUHAIT, aged 30 years, was last seen leaving 6 Basilisk Place, Whalan, after visiting an acquaintance. He has not been seen or heard from since.

Notice is hereby given that a reward of up to one hundred thousand dollars (\$100,000) will be paid by the Government of New South Wales for information leading to the arrest and conviction of the person or persons responsible for the disappearance and suspected death of Mohammed Ayman ABOUHAIT.

The allocation of this reward will be at the sole discretion of the Commissioner of Police.

The urgent assistance and co-operation of the public is especially sought in the matter. Any information, which will be treated as confidential, may be given at any time of the day or night at any Police Station or by telephone:

Police Headquarters telephone (02) 9281 0000  
or Crime Stoppers on 1800 333 000

The Hon. MICHAEL GALLACHER, M.L.C.,  
Minister for Police and Emergency Services  
and Minister for the Hunter

**PARENTS AND CITIZENS ASSOCIATIONS  
INCORPORATION ACT 1976**

## Incorporation of Parents and Citizens Associations

THE following associations are hereby incorporated under the Parents and Citizens Associations Incorporation Act 1976.

1. Rutherford Technology High School.
2. North Gosford Learning Centre.

ADRIAN PICCOLI, M.P.,  
Minister for Education



**PESTICIDES ACT 1999**

Notice under Section 48 (4)

NOTICE is hereby given, pursuant to section 48 (4) of the Pesticides Act 1999, that I have granted a Pilot (Pesticide Rating) Licence, particulars of which are stated in the Schedule.

SEAN NUNAN,  
Team Leader,  
Licensing and Registration  
(by delegation)

**SCHEDULE**

Pilot (Pesticide Rating) Licence

<i>Name and address of licensee</i>	<i>Date of granting of licence</i>
Russell KEILLOR, 3A Alpine Crescent, Grindelwald Tas 7277.	14 July 2011.

**PESTICIDES ACT 1999**

Notice under Section 48 (4)

NOTICE is hereby given, pursuant to section 48 (4) of the Pesticides Act 1999, that I have granted a Pilot (Pesticide Rating) Licence, particulars of which are stated in the Schedule.

SEAN NUNAN,  
Team Leader,  
Licensing and Registration  
(by delegation)

**SCHEDULE**

Pilot (Pesticide Rating) Licence

<i>Name and address of licensee</i>	<i>Date of granting of licence</i>
Nicholas LONG, PO Box 24, Manjimup WA 6258.	19 July 2011.

**PUBLIC HEALTH ACT 2010**

Public Health (Code of Conduct for Certain Health Practitioners) Regulation 2011

THE NSW Department of Health proposes to make the Public Health (Code of Conduct for Certain Health Practitioners) Regulation 2011.

In accordance with the requirements of the Public Health Act 2010, an impact assessment statement has been prepared to discuss the details of the proposed Regulation and to give interested parties an opportunity to make submissions on the proposed Regulation.

To facilitate public consultation a copy of the impact assessment statement and the proposed Regulation may be obtained from the Department of Health's Internet site [www.health.nsw.gov.au](http://www.health.nsw.gov.au) or by contacting the Department's Legal and Legislation and Corporate Governance Branch at [legalmail@doh.health.nsw.gov.au](mailto:legalmail@doh.health.nsw.gov.au).

Comments and submissions will be accepted until 9 September 2011.

**SYDNEY WATER ACT 1994**

Land Acquisition (Just Terms Compensation) Act 1991

Notice of Compulsory Acquisition of Easements at Kurnell

SYDNEY WATER CORPORATION declares, with the approval of Her Excellency, the Governor, that all of the estate and interests including native title interests if any in the land described in the schedules hereto are acquired by compulsory process under the provisions of the Land Acquisition (Just Terms Compensation) Act 1991 for the purpose of the Sydney Water Act 1994.

Dated at Parramatta this 19th day of July 2011.

Signed for Sydney Water Corporation by its Attorneys, Mark Rowley and Robert Edward Seymour, who hereby state at the time of executing this instrument have no notice of the revocation of the Power of Attorney Registered No. 606 Book 4541 under the Authority of which this instrument has been executed.

**SCHEDULE 1**

A Stratum Easement for Water Desalination Purposes more fully described in Clauses 1 to 4 inclusive and Schedule 1 of memorandum registered AF950422 at the Land and Property Management Authority NSW, over those pieces or parcels of land in the Local Government Area of Sutherland Shire (unincorporated area), Parish of Sutherland, County of Cumberland, and State of NSW being part of Lot 1 in DP 1136857 defined on DP 1136857 as "(A) PROPOSED STRATUM EASEMENT FOR WATER DESALINATION PURPOSES 30 WIDE (8455 m<sup>2</sup>)" for the benefit of Lot 2 in Deposited Plan 1077972 and Lot 1 in Deposited Plan 1088703.

**SCHEDULE 2**

A Stratum Easement for Water Desalination Purposes more fully described in Clauses 1 to 4 inclusive and Schedule 1 of memorandum registered AF950422 at the Land and Property Management Authority NSW, over those pieces or parcels of land in the Local Government Area of Sutherland Shire (unincorporated area), Parish of Sutherland, County of Cumberland, and State of NSW being part of Lot 1 in DP 1136857 defined on DP 1136857 as "(B) PROPOSED STRATUM EASEMENT FOR WATER DESALINATION PURPOSES 30 WIDE (1.073 ha)" for the benefit of Lot 2 in Deposited Plan 1077972 and Lot 1 in Deposited Plan 1088703.

**SCHEDULE 3**

An Easement for Desalination Purposes more fully described in Clauses 1 to 4 inclusive and Schedule 2 of memorandum registered AF950422 at the Land and Property Management Authority NSW, over those pieces or parcels of land in the Local Government Area of Sutherland Shire (unincorporated area), Parish of Sutherland, County of Cumberland, and State of NSW being part of Lot 1 in DP 1136857 defined on DP 1136857 as "(C) PROPOSED EASEMENT FOR DESALINATION PURPOSES (ENTIRE LOT) VAR. WIDTH (86.84ha) for the benefit of Lot 2 in Deposited Plan 1077972 and Lot 1 in Deposited Plan 1088703.

[Sydney Water reference: (2008/25085f)]

**SYDNEY WATER ACT 1994**

Land Acquisition (Just Terms Compensation) Act 1991

Notice of Compulsory Acquisition of Easements at Arncliffe in the Local Government Area of Rockdale

SYDNEY WATER CORPORATION declares, with the approval of Her Excellency, the Governor, that the interests in land described in the Schedules hereto are acquired by compulsory process under the provisions of the Land Acquisition (Just Terms Compensation) Act 1991 for the purpose of the Sydney Water Act 1994.

Dated at Parramatta this 19th day of July 2011.

Signed for Sydney Water Corporation by its Attorneys, Mark Rowley and Robert Edward Seymour, who hereby state at the time of executing this instrument have no notice of the revocation of the Power of Attorney Registered No. 606 Book 4541 under the Authority of which this instrument has been executed.

**SCHEDULE 1**

An Easement for Water Supply Purposes more fully described in Clauses 1, 2, 3 and 4 and Schedule 4 of Memorandum AF113568K lodged at the Land and Property Management Authority NSW, Sydney, over all that piece or parcel of land containing 3468 m<sup>2</sup> in the Local Government Area of Rockdale, Parish of St George, County of Cumberland, and State of New South Wales, being part of Lots 10 and 11 in Deposited Plan 570900, and shown on Deposited Plan 1152790 as “(A) PROPOSED STRATUM EASEMENT FOR WATER SUPPLY PURPOSES 6 WIDE”, said to be in the possession of Kogarah Golf Club Limited.

**SCHEDULE 2**

An Easement for Water Supply Purposes more fully described in Clauses 1, 2, 3 and 4 and Schedule 3 of Memorandum AF113568K lodged at the Land and Property Management Authority NSW, Sydney, over all that piece or parcel of land containing 64 m<sup>2</sup> in the Local Government Area of Rockdale, Parish of St George, County of Cumberland, and State of New South Wales, being part of Lot 10 in Deposited Plan 570900, and shown on Deposited Plan 1152790 as “(B) PROPOSED EASEMENT FOR WATER SUPPLY PURPOSES 8 WIDE”, said to be in the possession of Kogarah Golf Club Limited.

**SCHEDULE 3**

An Easement for Water Supply Purposes more fully described in Clauses 1, 2, 3 and 4 and Schedule 3 of Memorandum AF113568K lodged at the Land and Property Management Authority NSW, Sydney over all that piece or parcel of land containing 225 m<sup>2</sup> in the Local Government Area of Rockdale, Parish of St George, County of Cumberland, and State of New South Wales, being part of Lot 11 in Deposited Plan 570900, and shown on Deposited Plan 1152790 as “(C) PROPOSED EASEMENT FOR WATER SUPPLY PURPOSES (MOUNDED- NON TRAFFICABLE) 9 WIDE”, said to be in the possession of Kogarah Golf Club Limited.

**SCHEDULE 4**

An Easement for Water Supply Purposes more fully described in Clauses 1, 2, 3 and 4 and Schedule 1 of Memorandum AF113568K lodged at the Land and Property

Management Authority NSW, Sydney over all that piece or parcel of land containing 1120 m<sup>2</sup> in the Local Government Area of Rockdale, Parish of St George, County of Cumberland, and State of New South Wales, being part of Lot 11 in Deposited Plan 570900, and shown on Deposited Plan 1152790 as “(D) PROPOSED EASEMENT FOR WATER SUPPLY PURPOSES (MOUNDED-NON TRAFFICABLE) 8 WIDE”, said to be in the possession of Kogarah Golf Club Limited.

**SCHEDULE 5**

An Easement for Water Supply Purposes more fully described in Clauses 1, 2, 3 and 4 and Schedule 5 of Memorandum AF113568K lodged at the Land and Property Management Authority NSW Sydney, over all that piece or parcel of land containing 391 m<sup>2</sup> in the Local Government Area of Rockdale, Parish of St George, County of Cumberland, and State of New South Wales, being part of Lot 11, Deposited Plan 570900, and shown on Deposited Plan 1152790 as “(E) PROPOSED EASEMENT FOR WATER SUPPLY PURPOSES 8 WIDE”, said to be in the possession of Kogarah Golf Club Limited.

**SCHEDULE 6**

An Easement for Water Supply Purposes more fully described in Clauses 1, 2, 3 and 4 and Schedule 2 of Memorandum AF113568K lodged at the Land and Property Management Authority NSW Sydney, over all that piece or parcel of land containing 900 m<sup>2</sup> in the Local Government Area of Rockdale, Parish of St George, County of Cumberland, and State of New South Wales, being part of Lot 11 in Deposited Plan 570900, and shown on Deposited Plan 1152790 as “(J) PROPOSED EASEMENT FOR WATER SUPPLY PURPOSES (MOUNDED TRAFFICABLE) 9 WIDE”, said to be in the possession of Kogarah Golf Club Limited.

[Sydney Water reference: 2008/32381f]

**THE PORTS AND MARITIME ADMINISTRATION ACT 1995**

2011 Election of a Staff Director for each of the following:

Sydney Ports Corporation  
Newcastle Port Corporation  
Port Kembla Port Corporation

IN accordance with the provisions of the Ports and Maritime Administration Regulation 2007, the Returning Officer will conduct an election for a Staff Director for each of the following Port Corporations: Sydney Ports Corporation, Newcastle Port Corporation and Port Kembla Port Corporation.

**Nominations**

Nominations on the prescribed form (Form 1) are hereby invited. A person is entitled to be elected as the Staff Director to the Board of a Port Corporation whether or not the person is an employee of the Port Corporation. Candidates must give written consent to their nomination. Candidates must be nominated by at least two (2) persons (other than the candidate) who are employees of the respective Port Corporation.

For the purposes of the election “employee” means any member of the staff of the relevant Port Corporation, but

does not include a person who is employed on a temporary or casual basis.

A statutory declaration in support of candidature (Form 2) may be completed by each candidate, details of which will be included in a Candidate Information Sheet which will accompany ballot papers should an election be necessary.

Nomination forms (Form 1) and statutory declarations for candidate information sheet (Form 2) are available from the New South Wales Electoral Commission, telephone (02) 9290 5403 or toll free 1300 135 736, and the office of the Chief Executive Officer of each Port Corporation.

#### **Close of Nominations**

Nominations and statutory declarations in support of candidature must be received by the Returning Officer, New South Wales Electoral Commission, not later than NOON, Tuesday, 16 August 2011. They may be hand delivered to the New South Wales Electoral Commission, Level 25, 201 Kent Street, Sydney; posted to PO Box 693, Grosvenor Place NSW 1220 or faxed to (02) 9290 5939.

Any defect in a nomination or alterations or additions to a statutory declaration must be rectified by the candidate prior to the close of nominations ie: Noon, Tuesday, 16 August 2011. A candidate may only withdraw his/her nomination in writing so as to be received by the Returning Officer prior to the close of nominations.

#### **Voting**

Should more than the required number of nominations be received, a draw to determine the order of candidates' names on the ballot paper will be conducted at the New South Wales Electoral Commission at 2:00 p.m., Tuesday, 16 August 2011. Candidates or their representatives are invited to witness the draw.

If required a postal ballot will be conducted and will close at Noon, 14 September 2011. The count will be conducted at the New South Wales Electoral Commission, commencing at 9:00 a.m., on Thursday, 15 September 2011. Voting material will be posted on Wednesday, 24 August 2011, to all employees of the respective Ports Corporation.

The method of voting to be observed is optional preferential.

Any inquiries concerning the election should be directed to Jill Johnson at the New South Wales Electoral Commission, telephone (02) 9290 5403 or toll free 1300 135 736.

MICHAEL NEVIN,  
Returning Officer,  
NSW Electoral Commission

#### **TRANSPORT ADMINISTRATION ACT 1988 No. 109**

THE Minister for Transport has approved of the closure of the following public road overbridge under section 99B of the Transport Administration Act 1988 No. 109:

Public Road Overbridge near Allandale on the main Northern Line at rail kilometres 204.809.

All rights, easements and privileges in relation to this rail overbridge are now extinguished.

GLADYS BEREJIKLIAN, M.P.,  
Minister for Transport

#### **TRANSPORT ADMINISTRATION ACT 1988 No. 109**

THE Minister for Transport has approved of the closure of the following railway level crossing under section 99B of the Transport Administration Act 1988 No. 109:

Railway Level Crossings near Coggans Creek on the Ulan Line at rail kilometres 397.928 and 396.315; and

Closure of Level Crossing 395.904 and relocation to 395.924 near Coggans Creek on the Ulan Line

All rights, easements and privileges in relation to the closed railway level crossings are now extinguished.

A Public Accommodation Railway Level Crossing at rail kilometres 395.924 will be opened in lieu of the permanent closure of the 395.904 railway level crossing.

GLADYS BEREJIKLIAN, M.P.,  
Minister for Transport

# PRIVATE ADVERTISEMENTS

## COUNCIL NOTICES

### BELLINGEN SHIRE COUNCIL

Roads Act 1993, Section 10

Dedication of Land as Public Road

NOTICE is hereby given that the Bellingen Shire Council, by resolution of Council dated 22 July 2009, has resolved to dedicate the land described hereunder as public road pursuant to section 10 of the Roads Act 1993. LIZ JEREMY, General Manager, Bellingen Shire Council, PO Box 117, Bellingen NSW 2454.

#### SCHEDULE

Lot 1, DP 1147631. [5995]

### BELLINGEN SHIRE COUNCIL

Erratum

THE notification appearing in the *New South Wales Government Gazette* of 25 February 2011, Folio 1564, under the heading 'Roads Act 1993, Section 10, Dedication of Land as Public Road', showing Schedule 1 as Lot 1, DP 1147631, preceded the publication of the Notice of Acquisition of the land and is hereby taken to be withdrawn. ELIZABETH JEREMY, General Manager, Bellingen Shire Council, PO Box 117, Bellingen NSW 2454. [5996]

### CITY OF CANADA BAY COUNCIL

Local Government Act 1993, Section 50

Vesting of Drainage Reserves

IN the subdivision of land within the City of Canada Bay Council area, the land described in the schedule hereunder is marked "DRAIN" and reserved from sale in DP 1117. The City of Canada Bay Council is entitled under the Local Government Act 1993, to require the transfer of subject lands, now is it hereby notified under the provisions of section 50 (4) of the Local Government Act 1993, that such land is vested in the City of Canada Bay Council. G. SAWYER, General Manager, City of Canada Bay Council, Locked Bag 1470, Drummoyne NSW 1470.

#### SCHEDULE

Lot 37, Sec 3, DP 1117, being part of the residue of land in Certificate of Title Volume 612, Folio 25. [5997]

### GUNNEDAH SHIRE COUNCIL

Roads Regulation 2008

Part 2, Division 2

New Road Names

NOTICE is hereby given that Gunnedah Shire Council, in accordance with the Roads Regulation 2008, Part 2, Division 2, proposes that the public road adjoining the subdivision of Lot 2, DP 1155710, 17 Bushes Lane and Lots 23-36, DP 755474, 474 Wandobah Road, Gunnedah be named 'Robert Gordon Road'.

The subject road extends south from Bushes Lane, Gunnedah and is approximately 820 metres long.

No objections to the proposed name were received during the required 28 day exhibition period.

R. CAMPBELL, General Manager, Gunnedah Shire Council, PO Box 63, Gunnedah NSW 2340. [5998]

### MUSWELLBROOK SHIRE COUNCIL

Naming of Proposed Public Road

NOTICE is hereby given that Muswellbrook Shire Council, in pursuance of the Roads Act 1993 and Roads Regulation 2008, has approved the following new road names for gazettal:

<i>Deposited Plan/Location</i>	<i>Road Name</i>
Lot 20, DP 24649, Stage 13 – Eastbrook Links Estate, 8911 New England Highway, Muswellbrook.	Jeans Street, Lynch Street, Gore Street, Wright Circuit and extension of Henry Dangar Drive.

For further information please contact Council's Development Planner, Donna Watson on (02) 6549 3777. STEVE McDONALD, General Manager, Muswellbrook Shire Council, PO Box 122, Muswellbrook NSW 2333. [5999]

### THE CITY OF NEWCASTLE

Roads Act 1993, Section 10

Dedication of Land as Public Road

NOTICE is hereby given that in accordance with the provisions of section 10 of the Road Act 1993, the land held by Council as described in the Schedule below is hereby dedicated as public road. ROB NOBLE, Acting General Manager, The City of Newcastle, PO Box 489, Newcastle NSW 2300.

#### SCHEDULE

Lot 1 in Deposited Plan 1154183. [6000]

### RICHMOND VALLEY COUNCIL

Local Government Act 1993

Land Acquisition (Just Terms Compensation) Act 1991

Notice of Compulsory Acquisition of Land

RICHMOND VALLEY COUNCIL declares with the approval of Her Excellency the Governor that the land described in the Schedule below, excluding any mines or deposits of minerals in the land, is acquired by compulsory process in accordance with the provisions of the Land Acquisition (Just Terms Compensation) Act 1991, for water supply purposes. Dated at Casino, this 11th day of 2011. BRIAN WILKINSON, General Manager, Richmond Valley Council, Locked Bag 10, Casino NSW 2470.

#### SCHEDULE

Lot 21, DP 1159679. [6001]



**TAMWORTH REGIONAL COUNCIL**

Roads Act 1993

**ORDER**

Dedication of Land as Public Road

PURSUANT to the provisions of section 16, Roads Act 1993, the land specified in Schedule 1 is dedicated as a public road to the Roads Authority specified in Schedule 2 hereunder, as from the date of publication of this notice.

PAUL BENNETT, General Manager, Tamworth Regional Council, 437 Peel Street (PO Box 555), Tamworth, NSW, 2340

**SCHEDULE 1***Parish – Tamworth; County – Inglis**Land District – Tamworth**L.G.A. – Tamworth Regional Council*

The land described as Suburban Lot 7 in registered Deed Book 203 Number 74 excluding that part of the land conveyed to Nathan Cohen by registered Deed Book 210 Number 806 and that part of the land conveyed to John Patterson by registered Deed Book 340 Number 330, known locally as Alice Street.

**SCHEDULE 2***Parish – Tamworth; County – Inglis**Land District – Tamworth**L.G.A. – Tamworth Regional Council*

Roads Authority: Tamworth Regional Council. [6002]

**TWEED SHIRE COUNCIL**

Roads Act 1993

Naming of Public Bridge

NOTICE is hereby given that the Tweed Shire Council, in pursuance of section 162 of the Roads Act 1993, has named the bridge which crosses Snake Creek on Kyogle Road, Mt Burrell as:

Tom Grant Bridge

Authorised by resolution of the Council on 19 July 2011, General Manager, Tweed Shire Council, Civic Centre, Tumbulghum Road, Murwillumbah NSW 2484. [6003]

**WAGGA WAGGA CITY COUNCIL**

Roads Act 1993, Section 162

Roads Regulation 2008

Naming of Roads

NOTICE is hereby given that Wagga Wagga City Council, pursuant to the aforementioned Act and Regulation, has named/renamed the roads described hereunder.

<i>Description</i>	<i>Name</i>
M203, Euberta.	Belle Isle Lane.
Cooramin Street (between Boorooma Street and Messenger Avenue), Boorooma.	Durack Circuit.
Cooramin Street (between Messenger Avenue and the Olympic Highway), Boorooma.	Gibson Street.

Unnamed lane rear (south) of Hammond Avenue, between Koorringal Road and Marshalls Creek, East Wagga Wagga. Little Hammond Lane.

Isolated section of Byrnes Road, west of the Great Southern Railway from Bomen Road south for approximately 340 metres. Jersey Street.

Unnamed lane, between and parallel to, the Olympic Highway and O'Conner Street, Uranquinty. Miosge Lane.

PHIL PINYON, General Manager, Wagga Wagga City Council, PO Box 20, Wagga Wagga NSW 2650. [6004]

**ESTATE NOTICES**

NOTICE of intended distribution of estate. – Estate of RICHARD HOPPLECRY HUDSON, New South Wales Grant made 20 June 2011. – Any person having any claim upon the estate of Richard Hopplecry Hudson, late of Moonby, in the State of New South Wales, who died on 26 April 2011, must send particulars of the claim to the legal representative for the estate at c.o. C. P. White & Sons (Burwood), Solicitors, 15 Belmore Street, Burwood NSW 2134, not more than 30 days after publication of this notice. After that time the legal representative intends to distribute the property in the estate having regard only to the claims of which the legal representative had notice at the time of distribution. C. P. WHITE & SONS (Burwood), Solicitors, 15 Belmore Street, Burwood NSW 2134 (PO Box 36, Burwood NSW 1805), (DX 8550, Burwood), tel.: (02) 9744 2198. [6005]

NOTICE of intended distribution of estate. – Any person having any claim upon the estate of NINA RUTH McKENZIE, late of Belmont, in the State of New South Wales, domestic duties, who died on 31 May 2011, must send particulars of his/her claim to the executor, Garry James Walker, c.o. Lockhart Quinn & Co., 5 Library Lane, Charlestown NSW 2290, within thirty-one (31) days from publication of this notice. After that time and after six (6) months from the date of death of the deceased the assets of the estate may be conveyed and distributed having regard only to the claims, including any application or notice of intended application for a Family Provision Order, of which at the time of conveyance or distribution the executor has notice. Probate was granted in New South Wales on 13 July 2011. LOCKHART QUINN & CO., 5 Library Lane (PO Box 373), Charlestown NSW 2290 (DX 12611, Charlestown), tel.: (02) 4942 3222. [6006]

**OTHER NOTICES****ESSENTIAL ENERGY**

Electricity Supply Act 1995

Land Acquisition (Just Terms Compensation) Act 1991

Notice of Compulsory Acquisition of Easement for Electricity Purposes at Yeoval

ESSENTIAL ENERGY declares, with the approval of Her Excellency the Governor, with the advice of the Executive Council, that the Interest in Land described in Schedule 1 to this notice the terms of which are described in Schedule 2 to this notice is acquired by compulsory process in accordance

with the provisions of the Land Acquisition (Just Terms Compensation) Act 1991, for the purposes of the Electricity Supply Act 1995.

Dated at Port Macquarie this 22nd day of July 2011.  
TERRI BENSON, Managing Director, Essential Energy, PO  
Box 718, Queanbeyan NSW 2620.

---

SCHEDULE 1

Interest in Land: Easement for overhead powerlines 20 wide  
affecting Lot 145 in Deposited Plan 753240 shown as  
“Proposed easement for electricity purposes 20 wide”  
on DP 1164241.

Locality: Yeoval

LGA: Wellington

Parish: Loombah

County: Gordon

---

SCHEDULE 2

The easement for overhead powerlines 20 wide in  
Schedule 1 is on the terms set out in Part A of Memorandum  
No. AG189384 registered on the Register held under the Real  
Property Act 1900. [6007]

ISSN 0155-6320

---

Authorised to be printed  
DENIS H. HELM, Government Printer.